

# QJT-450B

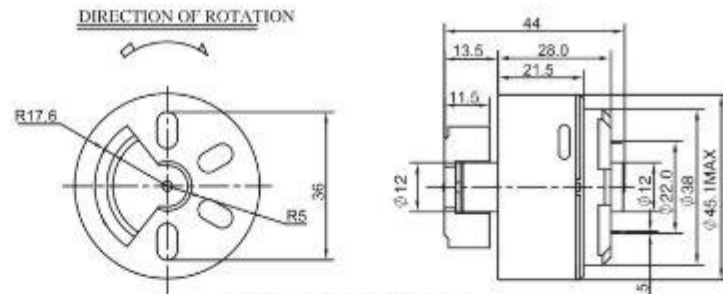

WEIGHT:134.2g(APPROX)

MODEL	VOLTAGE		NO LOAD		AT MAXIMUM EFFICIENCY				STALL			
	OPERATING RANGE	RATED	SPEED	CURRENT	SPEED	CURRENT	TORQUE	OUTPUT	TORQUE	CURRENT		
	V	V	rpm	A	rpm	A	g.cm	mN.m	W	g.cm	mN.m	A
QJT-450B	80-150	120	9290	0.055	6590	0.134	95.6	9.37	6.49	330	32.4	0.33
	2.5~3	2.5	7550	0.80	6090	3.36	87	8.5	5.46	454	44.5	14.1

