

SPECIFICATIONS

Current Rating: 3A AC, DC
 Contact Resistance: 20m Ω Max
 Insulation Resistance: 1000M Ω Min
 Withstanding Voltage: 1000V AC for 1 minute
 Temperature Range: -40°C to +105°C

MATERIAL

Contact: Brass
 Insulator: PBT, UL94V-0

ORDER INFORMATION

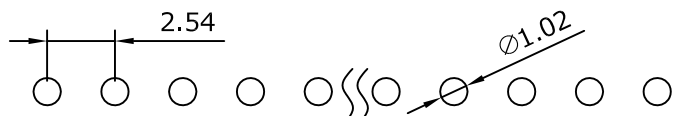
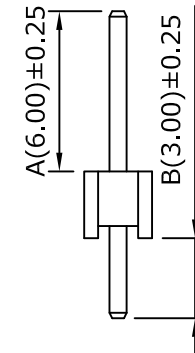
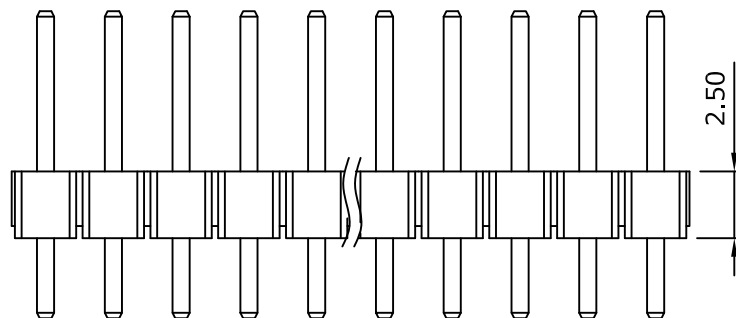
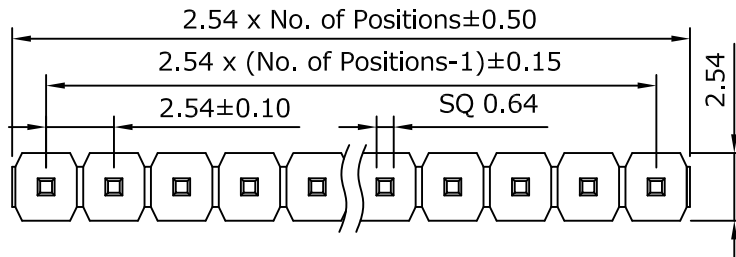
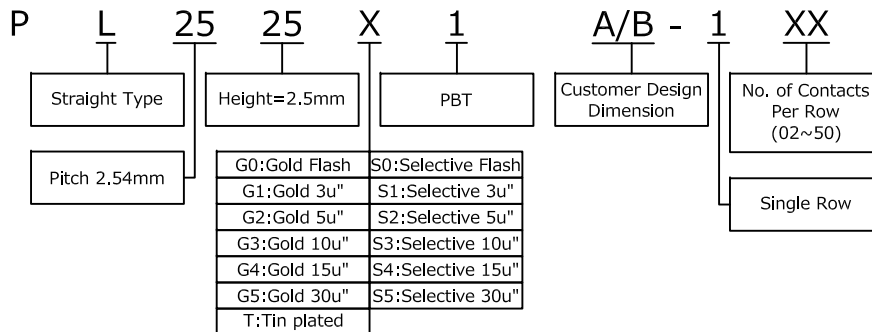

Recommended PCB Layout
 (PCB TOLERANCE ±0.05)

	PART NO.	PL2525X1 A/B-1XX	DRAWN	Andrew				
	DRAWING NO.	PL2525X1 A/B-1XX	CHECKED	Claudia				
	DATE	2005/05/01	APPROVED	Brian				
TITLE:	Pin Header 2.54mm H=2.5mm	REV. A0	TOLERANCE	.X ±0.25 .XX ±0.20	SCALE	1:1	UNIT	mm