

PK TYPE

●FEATURES

- 1、Contain high-frequency ferrite.
- 2、Comparatively large rated current.



●APPLICATIONS

- 1、Power supplies ,DC-DC converters.
- 2、TVs ,VTRs ,computers.
- 3、computer Peripherals.
- 4、Telephones , Air-Conditions .
- 5、Home Electric Appliance.
- 6、Electronic toys and games .

●PART NUMBERING SYSTEM (品名系統)

P K	0810	-	100	K	-	B
1	2		3	4		5
SERIES NAME	DIMENSIONS		INDUCTANCE	TOLERANCE CODE		PACKING CODE
品名	尺寸		電感值	公差		包裝
				J:±5%, K:±10%, L:±15%, R: Tape&Reel (卷裝)		M:±20%, P:±25%, N:±30% B: In Bulk (散裝)

●SHAPES AND DIMENSIONS (形狀及尺寸)

UNIT : mm

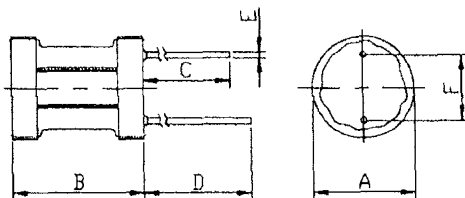

TYPE(型式)	φ A	B(max)	C(min)	D(min)	E	F
PK0304	3.5±0.5	6.0±1	10	15	0.5	1.3
PK0406	4.5±0.5	7.0±1	10	15	0.6	2.0
PK0507	5.5±0.5	9.0±1	10	15	0.6	2.5
PK0608	6.5±1.0	10.0±1	10	15	0.6	3.0
PK0707	7.5±1.0	9.0±1	10	15	0.6	4.8
PK0810	8.5±1.0	12.0±1	10	15	0.6	5
PK0912	9.5±1.0	14.0±1	10	15	0.6	5
PK1820	18.0(max)	20.0(max)	28.0	31	1.0	10.0

●STRUCTURAL DIAGRAM

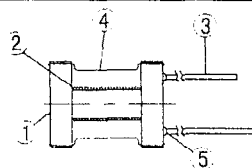

COMPONENT		MATERIALS
1.Core	磁芯	Ferrite core 鐵氧體磁芯
2.Wire	線材	Polyurethane enameled copper wires 漆包線
3.Lead wire	引腳	Tinned copper wires 錫包線
4.Tube	套管	Heat shrinkable tube,PVC or UL 熱縮套管
5.Glue	膠水	Epoxy resin 環氧樹脂

●CHARACTERISTICS

- Operating temperature range : -20°C to +105°C (include coil heat)
 Storage conditions : -20°C to +85°C
 DO NOT expose to direct sunlight(JIS C 805)

●特性

- 操作溫度範圍 : -20°C至+105°C (包括線圈熱度)
 貯存環境 : -20°C至+85°C 請不要直接暴露在陽光下 (JIS C 805)

Special inquiries besides the above common used types can be met on your requirement.
 超出以上規格的特殊要求也可滿足



RADIAL TYPE CHOKE INDUCTORS

立式扼流電感



PK0912 SERIES

SPECIFICATION TABLE:

PART NUMBER 品名	INDUCTANCE (μ H) 電感值	Q Min 品質系數	DCR (Ω)Max 直流電阻	IDC (mA)Max 定格電流	SRF (MHz)Min 自諧頻率	TEST FREQUENCY 測試頻率
PK0912-100K	10	110	0.04	2800	24	2.52MHz
PK0912-120K	12	110	0.04	2700	18	2.52MHz
PK0912-150K	15	110	0.05	2300	11	2.52MHz
PK0912-180K	18	90	0.06	2100	8.4	2.52MHz
PK0912-220K	22	90	0.07	2000	9.2	2.52MHz
PK0912-270K	27	90	0.10	1700	7.1	2.52MHz
PK0912-330K	33	90	0.12	1500	7.1	2.52MHz
PK0912-390K	39	80	0.12	1400	6.9	2.52MHz
PK0912-470K	47	70	0.13	1300	6.0	2.52MHz
PK0912-560K	56	70	0.14	1200	5.7	2.52MHz
PK0912-680K	68	60	0.15	1000	5.4	2.52MHz
PK0912-820K	82	50	0.16	900	4.6	2.52MHz
PK0912-101K	100	60	0.25	700	4.0	796KHz
PK0912-121K	120	60	0.28	700	3.6	796KHz
PK0912-151K	150	55	0.32	700	3.1	796KHz
PK0912-181K	180	55	0.47	600	2.8	796KHz
PK0912-221K	220	55	0.53	500	2.5	796KHz
PK0912-271K	270	50	0.60	450	2.4	796KHz
PK0912-331K	330	50	0.85	400	2.0	796KHz
PK0912-391K	390	50	0.95	350	2.1	796KHz
PK0912-471K	470	40	1.1	350	1.9	796KHz
PK0912-561K	560	30	1.2	300	1.8	796KHz
PK0912-681K	680	30	1.3	250	1.7	796KHz
PK0912-821K	820	30	1.4	200	1.5	796KHz
PK0912-102K	1000	70	2.0	200	1.1	252KHz
PK0912-122K	1200	70	2.3	180	1.0	252KHz
PK0912-152K	1500	70	2.9	150	1.0	252KHz
PK0912-182K	1800	70	3.3	120	0.9	252KHz
PK0912-222K	2200	70	4.5	110	0.7	252KHz
PK0912-272K	2700	70	5.5	90	0.7	252KHz
PK0912-332K	3300	60	5.7	80	0.6	252KHz
PK0912-392K	3900	60	6.5	80	0.6	252KHz
PK0912-472K	4700	60	7.2	60	0.6	252KHz
PK0912-562K	5600	60	9.5	50	0.5	252KHz
PK0912-682K	6800	60	11	50	0.5	252KHz
PK0912-822K	8200	50	13	50	0.4	252KHz
PK0912-103K	10000	120	16	40	0.3	79.6KHz
PK0912-123K	12000	120	18	40	0.3	79.6KHz
PK0912-153K	15000	110	21	40	0.3	79.6KHz
PK0912-183K	18000	110	23	40	0.3	79.6KHz
PK0912-223K	22000	110	33	35	0.2	79.6KHz
PK0912-273K	27000	100	37	35	0.2	79.6KHz
PK0912-333K	33000	90	42	35	0.2	79.6KHz
PK0912-393K	39000	90	45	30	0.2	79.6KHz
PK0912-473K	47000	80	52	30	0.2	79.6KHz

△Special inquiries besides the above common used types can be met on your requirement.
超出以上規格的特殊要求也可滿足