

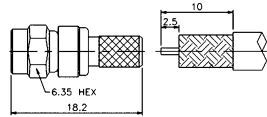

SMC Connectors

M52000
SMC MALE CRIMP TYPE (RG174U/178U)
(GOLD PLATED)



M52060
RIGHT ANGLE SMC FEMALE PCB MOUNT
(GOLD PLATED)

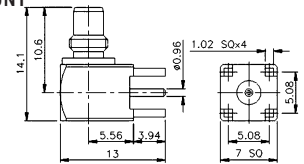

M52002
SMC MALE CRIMP TYPE (RG178U)
(GOLD PLATED)

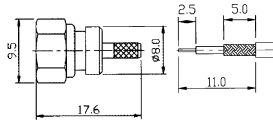
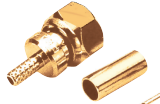

M52080
SMC MALE TO BNC FEMALE

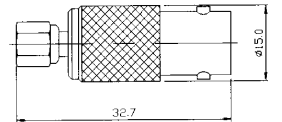

M52004
RIGHT ANGLE SMC MALE CRIMP TYPE
(RG174U/178U)
(GOLD PLATED)

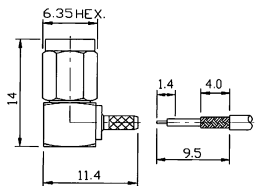

M52086
SMC FEMALE TO BNC MALE

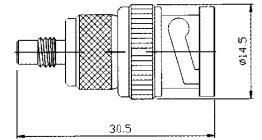

M52010
SMC MALE CLAMP TYPE (RG174U/178U)
(GOLD PLATED)

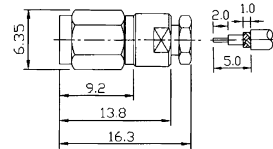

M52090
SMC MALE SOLDER TYPE
FOR SEMI-RIGID CABLE
(RG402U/405U)
(GOLD PLATED)

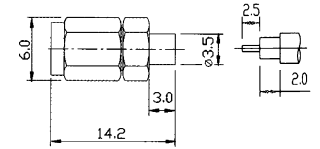

M52016
RIGHT ANGLE SMC MALE CLAMP TYPE
(RG174U/178U)
(GOLD PLATED)

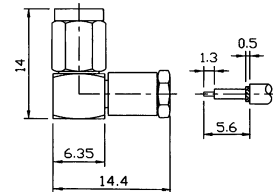

M52092
RIGHT ANGLE SMC MALE SOLDER TYPE
FOR SEMI-RIGID CABLE
(RG402U/405U) (GOLD PLATED)

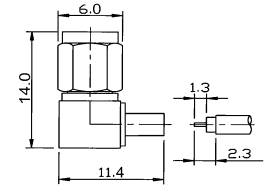

M52020
SMC FEMALE CRIMP TYPE
(RG174U/178U)
(GOLD PLATED)

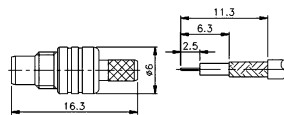

M52096
SMC FEMALE BULKHEAD SOLDER TYPE
FOR SEMI-RIGID CABLE
(RG402U/405U) (GOLD PLATED)

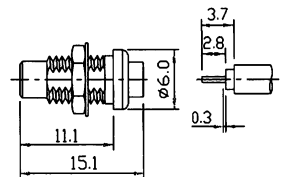

M52030
SMC FEMALE BULKHEAD
(GOLD PLATED)

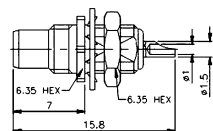

M52098
SMC FEMALE CHASSIS MOUNT
(RG402U/405U) (GOLD PLATED)

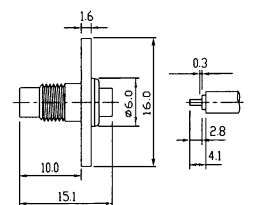

M52040
SMC FEMALE CHASSIS MOUNT
(GOLD PLATED)

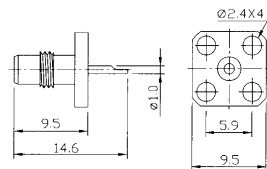

M52050
SMC FEMALE PCB MOUNT
(GOLD PLATED)

