

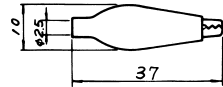

Clips

K260
 COLOR CLIP-SMALL
 COLOR : BLACK & RED
 W/VINYL BOOT



K267B
 ALLIGATOR CLIP W/MOLDED HANDLE
K267D
 ALLIGATOR CLIP W/O MOLDED HANDLE (SCREW)

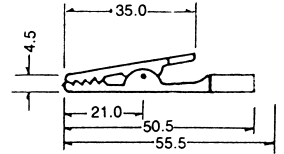

K261
 COLOR CLIP-MEDIUM
 COLOR : BLACK & RED
 W/VINYL BOOT

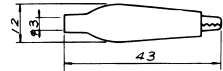

K268A
 IC CLIP (MINI TYPE)

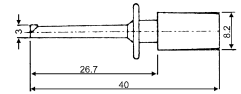

K262
 COLOR CLIP-LARGE
 COLOR : BLACK & RED
 W/VINYL BOOT

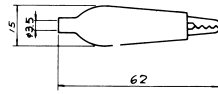

K268B
 IC CLIP (SMALL TYPE)

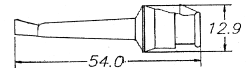

K263
 BATTERY CLIP 10A
 COLOR : BLACK & RED
 W/VINYL BOOT

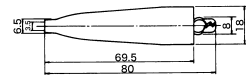

K268C
 IC CLIP (MEDIUM TYPE)

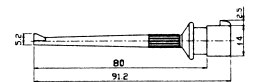

K264
 BATTERY CLIP 20A
 COLOR : BLACK & RED
 W/VINYL BOOT

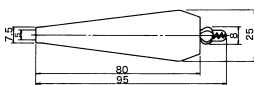

K268D
 IC CLIP (LARGE TYPE)

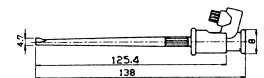

K265
 BATTERY CLIP 30A
 COLOR : BLACK & RED
 W/VINYL BOOT

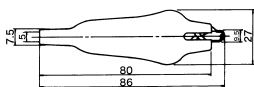

K26901~K26905
 ZERO INSERTION PRESSURE SOCKET

ROW SPACING
 A: 0.3 ~0.6 inch mix
 B: 0.3 inch
 C: 0.4 inch
 D: 0.6 inch
 E: 0.9 inch

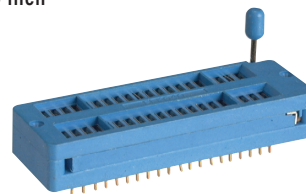
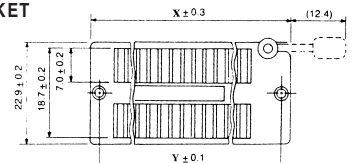

Item	Pins	X	Y
K26901	24	45.3	40.9
K26902	28	50.4	46.0
K26903	32	55.5	51.1
K26904	40	65.6	61.2
K26905	48	75.8	71.4

K266
 BATTERY CLIP W/COVERS
 (A) 15AMP (L:55mm)
 (B) 30AMP (L:70mm)
 (C) 50AMP (L:94mm)

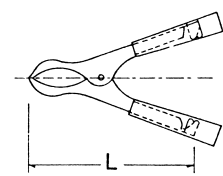
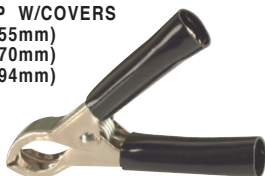

K267A
 ALLIGATOR CLIP-SMALL
 W/MOLDED HANDLE

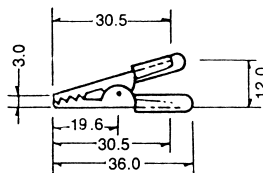

K26921~K26932
 IC TEST CLIPS

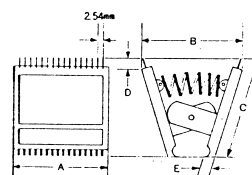
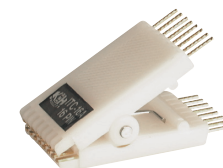

Item	Pins	Specification(mm)				
		A	B	C	D	E
K26921	8	13.0	27.0	44.5	6.00	5.50
K26922	14	20.5	25.0	44.5	6.00	5.50
K26923	16	23.0	23.0	44.5	8.00	5.00
K26924	18	25.5	26.0	44.5	6.00	5.50
K26925	20	28.0	25.0	44.5	8.00	5.00
K26926	22	30.5	27.0	44.5	6.00	5.50
K26927	24	32.0	30.0	44.5	7.00	5.00
K26928	28	37.0	29.0	44.5	7.00	5.50
K26929	36	48.0	29.0	44.5	6.00	5.50
K26930	40	52.5	29.0	44.5	6.50	5.50
K26931	48	63.0	29.0	44.5	6.00	5.50
K26932	64	83.0	33.0	44.5	6.00	5.50

K267C
 ALLIGATOR CLIP-LARGE
 W/SCREW
 W/MOLDED HANDLE

