

KP-3C

IGBT Snubber Capacitors

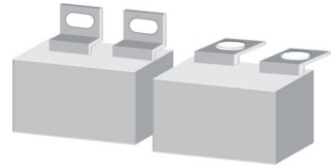

- Low inductance
- High DV/DT
- Low ESR
- Low loss polypropylene dielectric
- Impregnated elements eliminate corona

TYPICAL APPLICATIONS

High current, high current, high pulse applications such as IGBT protection circuits, snubber networks, energy conversion and control in

CONSTRUCTION

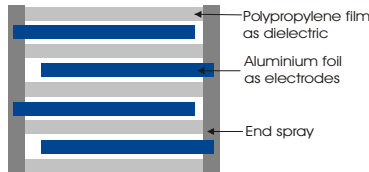

TECHNICAL SPECIFICATIONS

Dielectric material	Polypropylene film
Electrode material	Aluminium foil
Winding construction	Non-inductive, extended foil, impregnated
Lead material	Tinned copper
Enclosure	UL94V0 Preformed plastic case with thermosetting resin fill.
Rated voltage VDC	1000 1250 1500 2000
Rated voltage VAC	480 550 630 750
Capacitance range	0.1 F to 3.0 F
Capacitance Tol.	±5%(J); ±10%(K)
Test voltage	Between terminals 2.5 x rated voltage VDC for 2sec. Terminal to case 3KVAC at 50 Hz for 60 sec.
Temperature range	-40°C to +85°C
Insulation resistance	Measured at +25°C, 500VDC, 60 S C ≤ 0.33 F : ≥ 100,000M C > 0.33 F : ≥ 30,000 M
Dissipation factor Tan	≤ 0.0005 at 1 KHz and 25°C

MARKING ON CAPACITOR

Alcon logo and name; capacitor type(KP-3C); capacitance value and tolerance; voltage rating and manufacturing date code

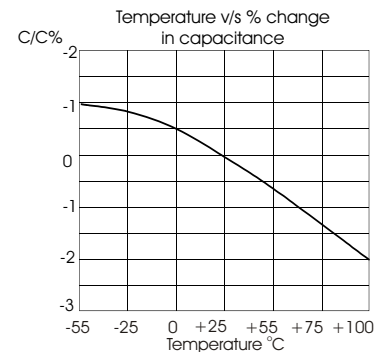
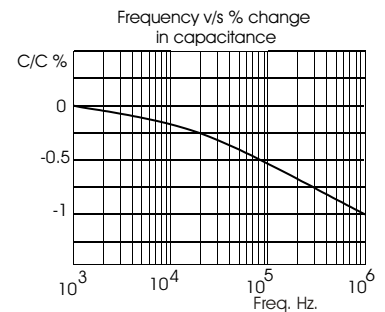
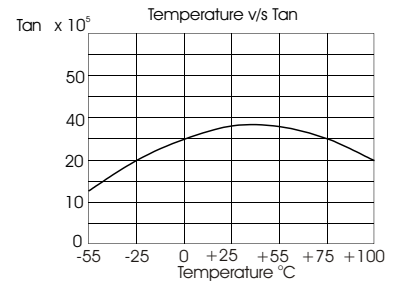
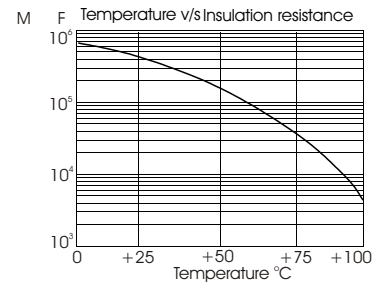
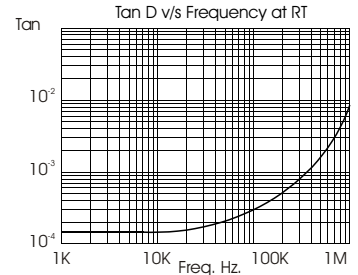

Working voltage 1000 Vdc (480 Vac at 50 Hz)

Rated capacitance MFD	Case code	DV/DT V/ S	I _{peak} Amps.	I _{rms} at 100 Khz and 55 deg. C	ESR max. at 100 Khz m	Terminal styles
0.10	K2	900	90	5.6	11.2	DL
0.15	K2	900	135	5.7	10.8	DL
0.22	K4	900	198	6.8	10.4	DL
0.22	B1	900	198	18.2	4.2	TL,RL,STL,FT,SL,MTL
0.22	C1	900	198	18.2	4.2	CR,CT
0.27	B1	900	243	18.7	4.0	TL,RL,STL,FT,SL,MTL
0.27	C1	900	243	18.7	4.0	CR,CT
0.33	B1	900	297	19.7	3.7	TL,RL,STL,FT,SL,MTL
0.33	C1	900	297	19.7	3.7	CR,CT
0.39	B1	900	351	20.6	3.7	TL,RL,STL,FT,SL,MTL
0.39	C1	900	351	20.6	3.5	CR,CT
0.47	B5	900	423	21.1	3.5	TL,RL,STL,FT,SL,MTL
0.56	B5	800	392	21.3	3.5	TL,RL,STL,FT,SL,MTL
0.68	B5	800	476	21.3	3.2	TL,RL,STL,FT,SL,MTL
0.75	B5,B2	800	525	25.6	3.0	TL,RL,STL,FT,SL,MTL
0.82	B5	800	574	26.0	3.0	TL,RL,STL,FT,SL,MTL
1.00	B5	900	900	26.0	3.0	TL,RL,STL,FT,SL,MTL
1.00	B3	800	900	26.0	3.0	TL,RL,STL,SL,MTL
1.20	B3	800	960	26.0	2.5	TL,RL,STL,SL,MTL
1.50	B3	800	1200	26.0	2.5	TL,RL,STL,SL,MTL
1.75	B4	500	875	28.0	2.5	TL,RL,STL,SL,MTL
2.00	B4	500	1000	28.2	2.5	TL,RL,STL,SL,MTL
2.20	C2	400	880	28.5	2.4	TL,RL,STL,SL,MTL
2.50	C2	400	1000	29.0	2.2	TL,RL,STL,SL,MTL
3.0	C2	400	1200	30.0	2.0	TL,RL,STL,SL,MTL

Working voltage 1250 Vdc (550 Vac at 50 Hz)

Rated capacitance MFD	Case code	DV/DT V/ S	I _{peak} Amps.	I _{rms} at 100 Khz and 55 deg. C	ESR max. at 100 Khz m	Terminal styles
0.10	K2	1000	100	5.6	11.2	DL
0.15	K2	1000	150	5.7	10.8	DL
0.22	K4	1000	220	6.8	10.4	DL
0.22	B1	1000	220	18.2	4.2	TL,RL,STL,FT,SL,MTL
0.22	C1	1000	220	18.2	4.2	CR,CT
0.27	B1	1000	270	18.7	4.0	TL,RL,STL,FT,SL,MTL
0.27	C1	1000	270	18.7	4.0	CR,CT
0.33	B1	1000	330	19.7	3.7	TL,RL,STL,FT,SL,MTL
0.33	C1	1000	330	19.7	3.7	CR,CT
0.39	B1	1000	390	20.6	3.7	TL,RL,STL,FT,SL,MTL
0.39	C1	1000	390	20.6	3.5	CR,CT
0.47	B5	1000	470	21.1	3.5	TL,RL,STL,FT,SL,MTL

Working voltage 1250Vdc (550 Vac at 50 Hz)

Rated capacitance MFD	Case code	DV/DT V/ S	I _{peak} Amps.	I _{rms} at 100 Khz and 55 deg. C	ESR max. at 100 Khz m	Terminal styles
0.56	B5	1000	560	21.3	3.5	TL,RL,STL,FT,SL,MTL
0.68	B5	900	612	21.3	3.2	TL,RL,STL,FT,SL,MTL
0.75	B5,B2	900	675	25.6	3.0	TL,RL,STL,FT,SL,MTL
0.82	B5	900	738	26.0	3.0	TL,RL,STL,FT,SL,MTL
1.00	B5	900	900	26.0	3.0	TL,RL,STL,FT,SL,MTL
1.00	B3	1000	1000	26.0	3.0	TL,RL,STL,SL,MTL
1.20	B3	900	1080	26.0	2.5	TL,RL,STL,SL,MTL
1.50	B3	900	1350	26.0	2.5	TL,RL,STL,SL,MTL
1.75	B4	600	1050	28.0	2.5	TL,RL,STL,SL,MTL
2.00	B4	600	1100	28.2	2.5	TL,RL,STL,SL,MTL
2.20	C2	500	880	28.5	2.4	TL,RL,STL,SL,MTL
2.50	C2	500	1250	29.0	2.2	TL,RL,STL,SL,MTL
3.0	C2	500	1500	30.0	2.0	TL,RL,STL,SL,MTL

Working voltage 1500Vdc (630 Vac at 50 Hz)

Rated capacitance MFD	Case code	DV/DT V/ S	I _{peak} Amps.	I _{rms} at 100 Khz and 55 deg. C	ESR max. at 100 Khz m	Terminal styles
0.10	K2	1100	110	5.6	11.2	DL
0.15	K2	1100	165	5.7	10.8	DL
0.22	K4	1100	242	6.8	10.4	DL
0.22	B1	1100	242	18.2	4.2	TL,RL,STL,FT,SL,MTL
0.22	C1	1100	242	18.2	4.2	CR,CT
0.27	B1	1100	297	18.7	4.0	TL,RL,STL,FT,SL,MTL
0.27	C1	1100	297	18.7	4.0	CR,CT
0.33	B1	1100	363	19.7	3.7	TL,RL,STL,FT,SL,MTL
0.33	C1	1100	363	19.7	3.7	CR,CT
0.39	B1	1100	429	20.6	3.7	TL,RL,STL,FT,SL,MTL
0.39	C1	1100	429	20.6	3.5	CR,CT
0.47	B5	1100	517	21.1	3.5	TL,RL,STL,FT,SL,MTL
0.56	B5	1000	560	21.3	3.5	TL,RL,STL,FT,SL,MTL
0.68	B5	1000	680	21.3	3.2	TL,RL,STL,FT,SL,MTL
0.75	B5,B2	1000	750	25.6	3.0	TL,RL,STL,FT,SL,MTL
0.82	B5	1000	820	26.0	3.0	TL,RL,STL,FT,SL,MTL
1.00	B3	1000	1000	26.0	3.0	TL,RL,STL,SL,MTL
1.20	B3	1000	1200	26.0	2.5	TL,RL,STL,SL,MTL
1.50	B3	1000	1500	26.0	2.5	TL,RL,STL,SL,MTL
1.75	B4	700	1225	28.0	2.5	TL,RL,STL,SL,MTL
2.00	B4	700	1400	28.2	2.5	TL,RL,STL,SL,MTL
2.20	C2	600	1320	28.5	2.4	TL,RL,STL,SL,MTL
2.50	C2	600	1500	29.0	2.2	TL,RL,STL,SL,MTL
3.0	C2	600	1800	30.0	2.0	TL,RL,STL,SL,MTL

Working voltage 2000Vdc (750 Vac at 50 Hz)

Rated capacitance MFD	Case code	DV/DT V/ S	I _{peak} Amps.	I _{rms} at 100 Khz and 55 deg. C	ESR max. at 100 Khz m	Terminal styles
0.10	B1	1300	130	13.2	8.4	TL,RL,STL,FT,MTL
0.15	B5	1200	180	15.11	7.0	TL,RL,STL,SL,FT,MTL
0.22	B5	1200	264	19.8	4.5	TL,RL,STL,SL,FT,MTL
0.27	B5	1200	324	21.7	4.3	TL,RL,STL,SL,FT,MTL
0.33	B3	1200	396	22.2	4.1	TL,RL,STL,MTL
0.39	B3	1200	468	22.5	4.0	TL,RL,STL,MTL
0.47	B3	1200	564	22.5	4.0	TL,RL,STL,MTL
0.56	B4	1000	560	22.7	3.8	TL,RL,STL,MTL
0.68	B4	1000	680	22.8	3.7	TL,RL,STL,MTL
0.75	C2	800	600	23.2	3.4	TL,RL,STL,MTL
0.82	C2	800	656	23.2	3.3	TL,RL,STL,MTL
1.00	C2	800	800	23.3	3.2	TL,RL,STL,MTL

CASE SIZES IN MM

Case code	Size			Mounting Pitch	Ymin.	Terminal styles
	B±1	H±1	L±1	P±0.5		
K2	11	20	32	27.5	--	DL
K3	13	22	32	27.5	--	DL
K4	14	24	32	27.5	--	DL
B1	17	29	41.5	32.5,39.0	-	DL,FT,2P
B1	17	29	41.5	25.5	8.5	TL,RL,STL,SL
B1	17	29	41.5	25.5	11.5	MTL
B2	24	38	48	27.0	11.5	TL,RL,STL,SL
B2	24	38	48	27.0	13.0	MTL
B3	30	45	45	39.0	-	FT,2P
B3	30	45	45	27.0	13.0	MTL
B4	30	50	54	27.0	11.5	TL,RL,STL,SL
B4	30	50	54	48.0	-	3P
B4	30	50	54	55.0	28.0	CL
B4	30	50	54	27.0	13.0	MTL
B5	28	30	45	27.0	11.5	TL,RL,STL,SL
B5	28	30	45	27.0	13.5	MTL
B5	28	30	45	39.0	-	FT,2P
C1	18	33	38	-	-	CR,CT,AB
C2	43	50	54	27.0	11.5	TL,RL,STL,SL
C2	43	50	54	27.0	13.5	MTL
C2	43	50	54	55.0	28.0	CL
C2	43	50	54	48.0	-	4P

DIMENSIONAL DETAILS AND TERMINAL OPTIONS

Terminal style : DL

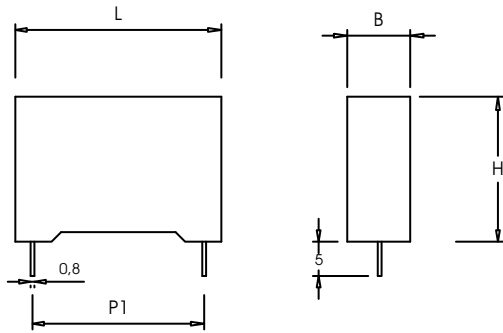

CASE CODE : K2, K3, K4
FOR DETAILS SEE CASE CODE TABLE

Terminal style : SL

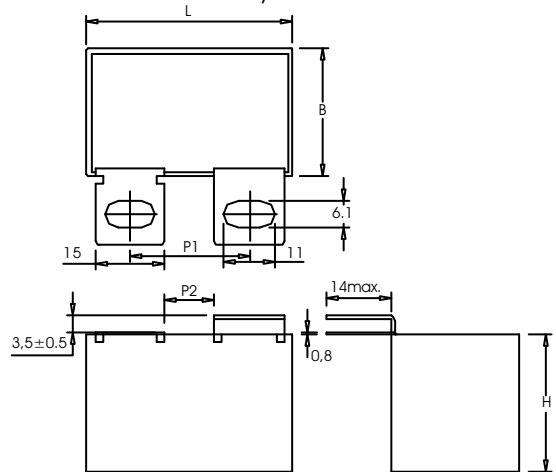

CASE CODE : B1, B2, B3, B4, B5, C2
FOR DETAILS SEE CASE CODE TABLE

Terminal style : TL

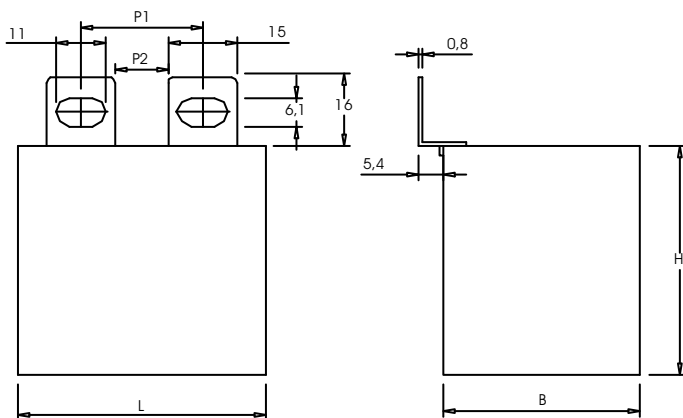

CASE CODE : B1, B2, B3, B4, B5, C2
FOR DETAILS SEE CASE CODE TABLE

Terminal style : RL

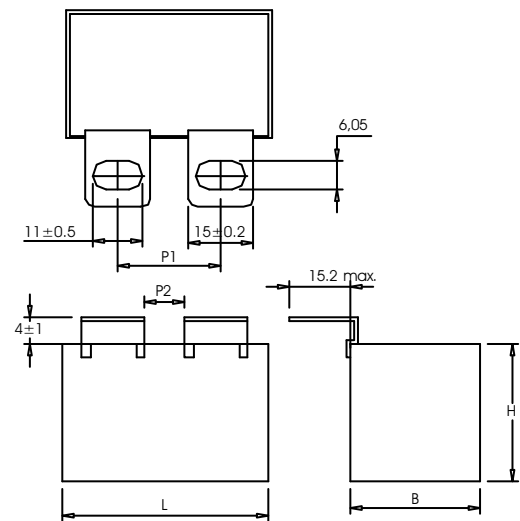

CASE CODE : B1, B2, B3, B4, B5, C2
FOR DETAILS SEE CASE CODE TABLE

DIMENSIONAL DETAILS AND TERMINAL OPTIONS

Terminal style : FT

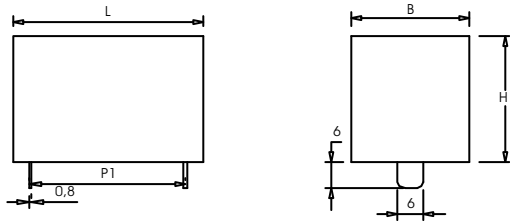

CASE CODE : B1,B2,B5
FOR DETAILS SEE CASE CODE TABLE

Terminal style : STL

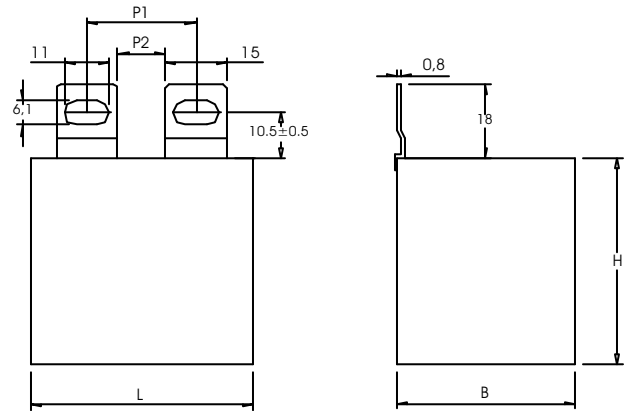

CASE CODE : B1,B2,B3,B4,B5,C2
FOR DETAILS SEE CASE CODE TABLE

Terminal style : MTL

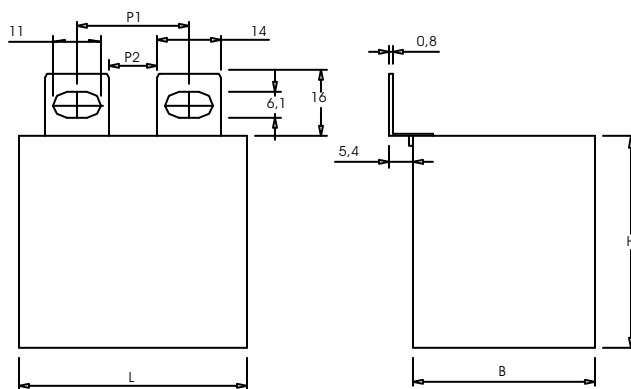

CASE CODE : B1,B2,B3,B4,B5,C2
FOR DETAILS SEE CASE CODE TABLE

Terminal style : CL

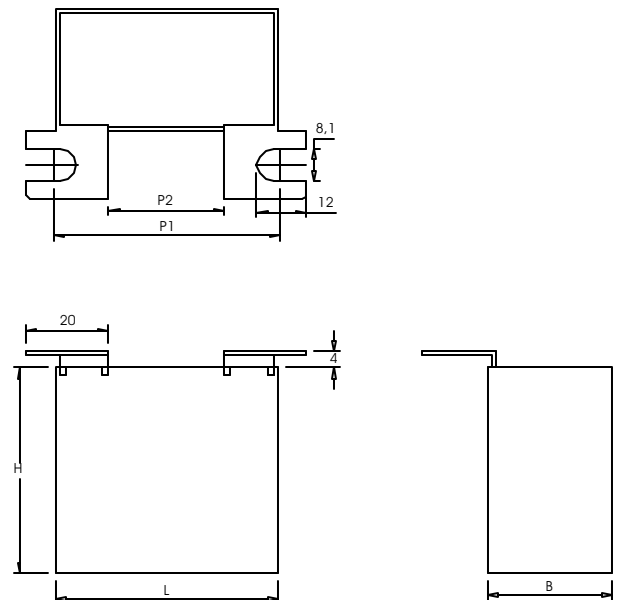

CASE CODE : B4,C2
FOR DETAILS SEE CASE CODE TABLE

DIMENSIONAL DETAILS AND TERMINAL OPTIONS

Terminal style : CT

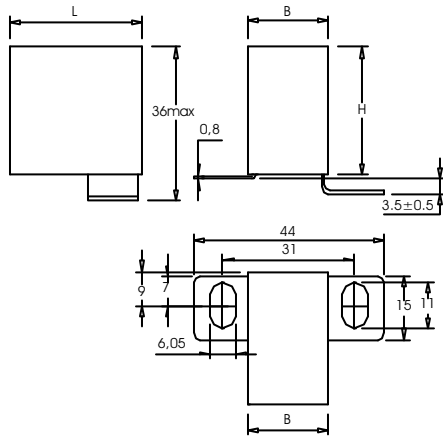

CASE CODE : C1
FOR DETAILS SEE CASE CODE TABLE

Terminal style : CR

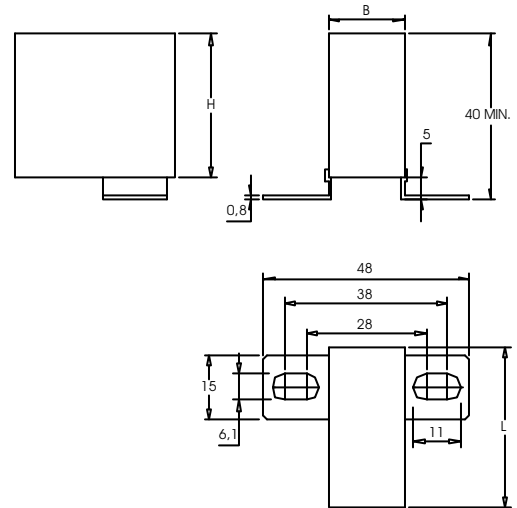

CASE CODE : C1
FOR DETAILS SEE CASE CODE TABLE

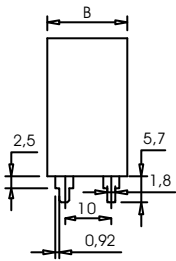

Terminal style : 2P
CASE CODE : B2,B3,B5

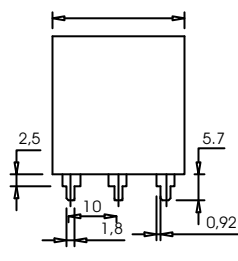

Terminal style : 3P
CASE CODE : B4

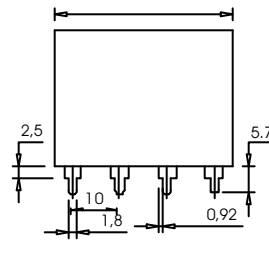

Terminal style : 4P
CASE CODE : C2

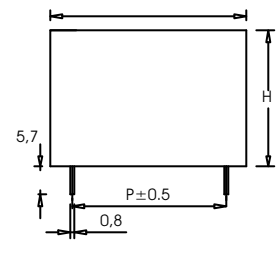

FOR DETAILS SEE CASE CODE TABLE



Custom designed capacitors are available on request

A6765 ISO9001



The specifications shown in this catalogue pertain to the current manufacturing range of the company. The Company reserves the right to change and/or modify any part of or the specifications as a result of research and development and as may be deemed necessary, without prior notice.