

M579300
Right angle 1.6/5.6 male clamp type gold-pin
(RG179U/3C2V)

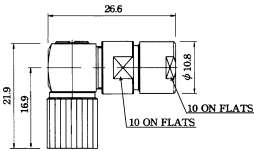

M579320
Right angle 1.6/5.6 male crimp type gold-pin
(RG179U/3C2V)

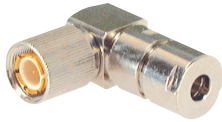
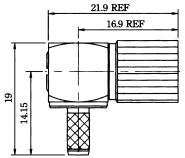

M579302
Right angle 1.6/5.6 female clamp type gold-pin
(RG179U/3C2V)

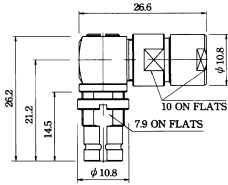
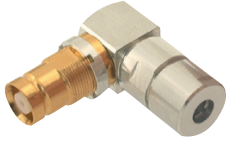

M579322
1.6/5.6 male PCB mount gold-pin

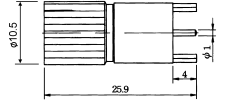

M579304
Right angle 1.6/5.6 male PCB mount gold-pin

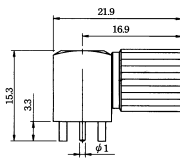

M579324
U-type 1.6/5.6 male to male gold-pin

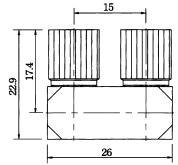
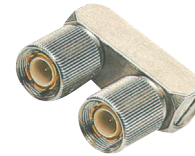

M579306
Right angle 1.6/5.6 female PCB mount gold-pin

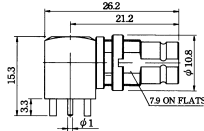

M579330
1.6/5.6 Female clamp type gold-pin
(RG179U/3C2V)

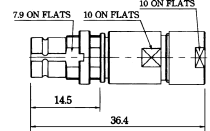

M579308
1.6/5.6 Female PCB mount
(gold plated)

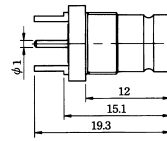

M579332
1.6/5.6 Male clamp type gold-pin
(RG179U/3C2V)

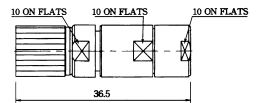

M579310
1.6/5.6 Female bulkhead
(gold plated)

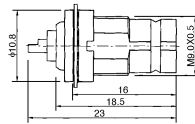

M579335
1.6/5.6 Female to female
(gold plated)

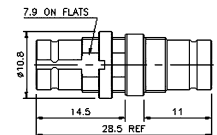

M579314
1.6/5.6 Female crimp type gold-pin
(RG179U/3C2V)

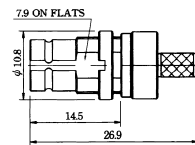

M579337
T-type 1.6/5.6 male to female gold-pin

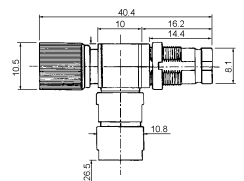

M579316
1.6/5.6 Male crimp type gold-pin
(RG179U/3C2V)

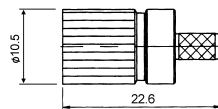

M579339
T-type 1.6/5.6 male to double female gold-pin

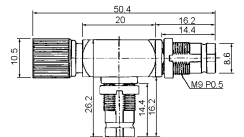

M579318
Right angle 1.6/5.6 female crimp type gold-pin
(RG179U/3C2V)

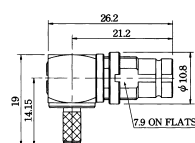

M579340
Y-type 1.6/5.6 female to double male gold-pin

