

# DIL Switches

## Low Profile

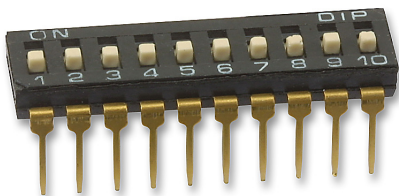

### NDI

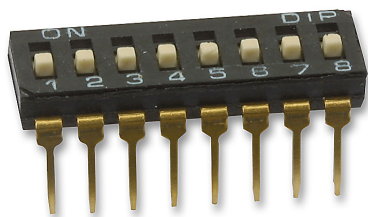
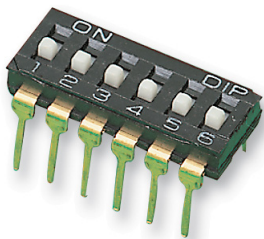
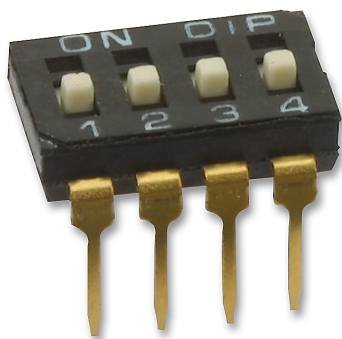
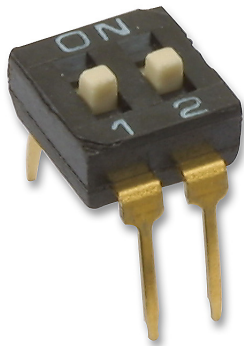

### Features:

- Single pole single throw DIL switches.
- Splay terminals allow for automatic insertion by IC insertion machine.
- Insert moulding of terminals and ultrasonic welding improve flux proofness and enable flux washing in whole by top tape sealing.
- NDI series (raised actuator) available for different purposes.
- Double contacts offers high reliability.
- Vapour phase solderable, IR-reflow solderable.
- Terminal plating by gold give excellent results when soldering.

Terminal plating : Tin/lead available too.  
Lead Spacing : 7.62 x 2.54.

### Materials:

Base and Cover : High temperature thermoplastic.  
Colour : Black.

Actuator : Nylon thermoplastic.  
Colour : White.

Contact : Gold plated over nickel.

Terminal : Gold.

Tape plating : Kapton.

Life expectancy : 2000 ops.

It is recommended to solder switches in the 'off' factory supplied position.

### Specifications:

#### Mechanical:

Mechanical life : 2000 operations per switch.

Operation force : 1000gf maximum.

Storage temperature : -40°C to +85°C.

Vibration test : MIL-STD-202F Method 201A.

Frequency : 10 - 55 - 10Hz/1minute.

Directions : X, Y, Z three mutually perpendicular directions.

Time : 2 hours each direction.

High reliability.

Shock test : MIL-STD-202F Method 213B.

Condition A.

Gravity : 50G (peak value), 11m seconds.

Direction and times : 6 sides and 3 times in each direction.

High reliability.



# DIL Switches

## Low Profile



### NDI

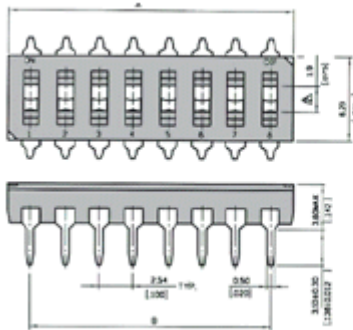

### NDI- S

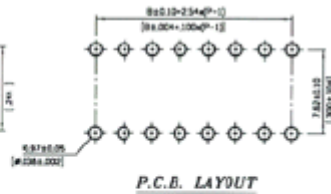
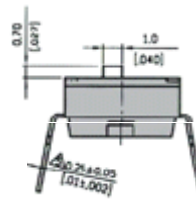

### Schematic (Typical)



02, 04, 06, 08 and 10 Position Available

### DMR

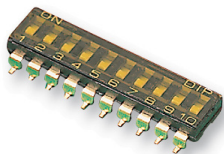
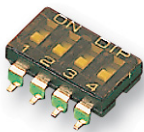

### Specifications:

#### Electrical:

Electrical life : 2000 operations minimum per switch 24Vdc, 25mA.

Non-switching rating : 100mA, 50Vdc.

Stroke : NDI Series : 1.0mm.  
DM(R) Series : 0.9mm.

Switching rating : 25mA 24Vdc.

Contact resistance : [a] 50mΩ maximum at initial.  
[b] 100mΩ maximum after life test.

Capacitance : 5pF maximum.

Operating temperature : -20°C to +70°C.

Insulation resistance : 100MR at 500V.

Dielectric Strength : 500Vac 1minute.

Contact rating : 25mA 24Vdc and 100mA 50Vdc non switching.

### Soldering and cleaning process:

#### For best results, please follow these recommendation:

Keep all switch contacts in their "OFF" position for all operations.

Wave soldering : Recommended solder temperature at 500°F (260°C) maximum, 5 seconds.  
For through hole type.

Hand soldering : Use a soldering iron of 30 watts, controlled at 608°F (320°C) approximately 2 seconds while applying solder.



# DIL Switches

## Low Profile

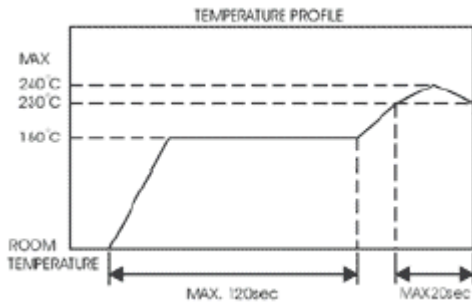

Reflow temperature profile.

Care should be exercised so that flux from the upper part of the printed circuit board does not adhere to the switch.

Do not clean the switch body except with top tape sealed type, which can only spray of cleaning method from top s/w.

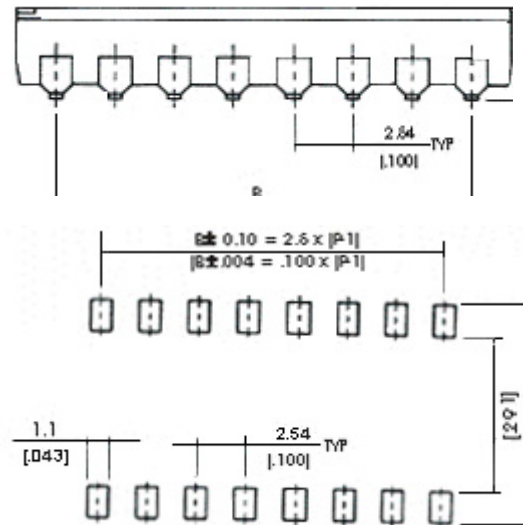
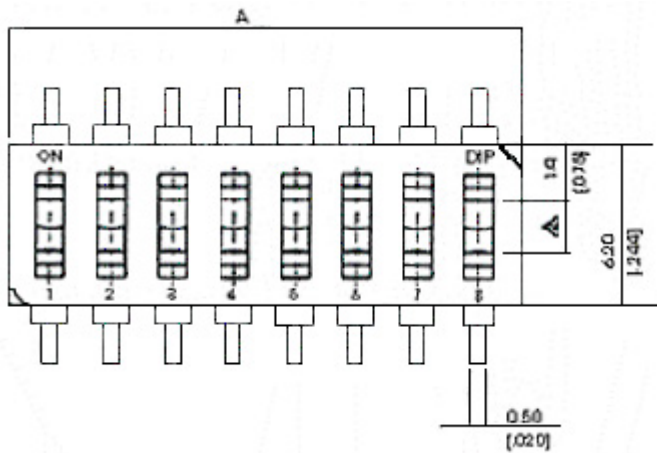

### Terminal Type

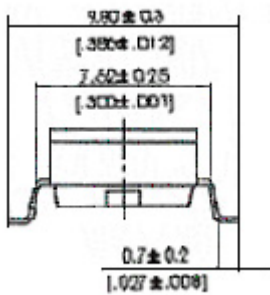

### DMR SERIES

General Tolerance:  $\pm 0.2\text{mm}$  ( $\pm 0.008''$ )



# DIL Switches

## Low Profile



### Models For NDI

Number of ways	Dimension A	Dimension B	Part Number
02	6.02 (0.237)	2.54 (0.100)	MCNDI-02S
04	11.10 (0.437)	7.62 (0.300)	MCNDI-04S
06	16.18 (0.637)	12.70 (0.500)	MCNDI-06S
08	21.26 (0.837)	17.78 (0.700)	MCNDI-08S
10	26.34 (1.037)	22.86 (0.900)	MCNDI-10S

Dimensions : Millimetres (Inches)

### Models For DM(R)

Number of Ways	Dimension A	Dimension B	Part Number
2	6.02 (0.237)	2.54 (0.100)	MCDM(R)-02-T
4	11.10 (0.437)	7.62 (0.300)	MCDM(R)-04-T
6	16.18 (0.637)	12.70 (0.500)	MCDM(R)-06-T
8	21.26 (0.837)	17.78 (0.700)	MCDM(R)-08-T
10	26.34 (1.037)	22.86 (0.900)	MCDM(R)-10-T

Dimensions : Millimetres (Inches)

### Part Number Explanation:

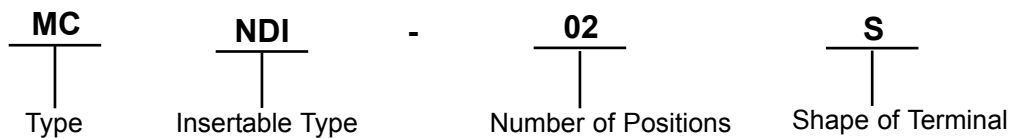

**Insertable Type** : NDI = Machine insertable Type DIP switch.

**Number of Positions** : 02, 04, 06, 08 and 10.

**Shape Of Terminal** : S = Splay Terminal.

### Part Number Explanation

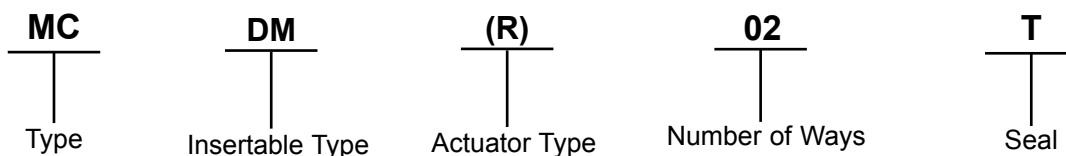

**Insertable Type** : Surface Mounting Type DIP Switch.

**Actuator Type** : Recessed Acuator.

**Number of Ways** : 02, 04, 06, 08 and 10.

**Seal** : T = Top Tape Sealed.



# DIL Switches

## Low Profile



### Notes:

### International Sales Offices:



**AUSTRALIA – Farnell InOne**  
Tel No: ++ 61 2 9645 8888  
Fax No: ++ 61 2 9644 7898



**FINLAND – Farnell InOne**  
Tel No: ++ 358 9 560 7780  
Fax No: ++ 358 9 345 5411



**NETHERLANDS – Farnell InOne**  
Tel No: ++ 31 30 241 7373  
Fax No: ++ 31 30 241 7333



**SWITZERLAND – Farnell InOne**  
Tel No: ++ 41 1 204 64 64  
Fax No: ++ 41 1 204 64 54



**AUSTRIA – Farnell InOne**  
Tel No: ++ 43 662 2180 680  
Fax No: ++ 43 662 2180 670



**FRANCE – Farnell InOne**  
Tel No: ++ 33 474 68 99 99  
Fax No: ++ 33 474 68 99 90



**NEW ZEALAND – Farnell InOne**  
Tel No: ++ 64 9 357 0646  
Fax No: ++ 64 9 357 0656



**UK – Farnell InOne**  
Tel No: ++ 44 8701 200 200  
Fax No: ++ 44 8701 200 201



**BELGIUM – Farnell InOne**  
Tel No: ++ 32 3 475 2810  
Fax No: ++ 32 3 227 3648



**GERMANY – Farnell InOne**  
Tel No: ++ 49 89 61 39 39 39  
Fax No: ++ 49 89 613 59 01



**NORWAY – Farnell InOne**  
Tel No: ++ 45 44 53 66 66  
Fax No: ++ 45 44 53 66 02



**UK – BuckHickman InOne**  
++ 44 8450 510 150  
++ 44 8450 510 130



**BRAZIL – Farnell-Newark InOne**  
Tel No: ++ 55 11 4066 9400  
Fax No: ++ 55 11 4066 9410



**HONG KONG – Farnell-Newark InOne**  
Tel No: ++ 852 2268 9888  
Fax No: ++ 852 2268 9899



**PORTUGAL – Farnell InOne**  
Tel No: ++ 34 93 475 8804  
Fax No: ++ 34 93 474 5288



**UK – CPC**  
++ 44 8701 202 530  
++ 44 8701 202 531



**CHINA – Farnell-Newark InOne**  
Tel No: ++86 10 6238 5152  
Fax No: ++86 10 6238 5022



**IRELAND – Farnell InOne**  
Tel No: ++ 353 1 830 9277  
Fax No: ++ 353 1 830 9016



**SINGAPORE – Farnell-Newark InOne**  
Tel No: ++ 65 6788 0200  
Fax No: ++ 65 6788 0300



**EXPORT – Farnell InOne**  
Tel No: ++ 44 8701 200 208  
Fax No: ++ 44 8701 200 209

For enquiries from all other markets



**DENMARK – Farnell InOne**  
Tel No: ++ 45 44 53 66 44  
Fax No: ++ 45 44 53 66 06



**ITALY – Farnell InOne**  
Tel No: ++ 39 02 93 995 200  
Fax No: ++ 39 02 93 995 300



**SPAIN – Farnell InOne**  
Tel No: ++ 34 93 475 8805  
Fax No: ++ 34 93 474 5107



**ESTONIA – Farnell InOne**  
Tel No: ++ 358 9 560 7780  
Fax No: ++ 358 9 345 5411



**MALAYSIA – Farnell-Newark InOne**  
Tel No: ++ 60 3 7873 8000  
Fax No: ++ 60 3 7873 7000



**SWEDEN – Farnell InOne**  
Tel No: ++ 46 8 730 50 00  
Fax No: ++ 46 8 83 52 62

<http://www.farnellinone.com>

<http://www.buckhickmaninone.com>

<http://www.cpc.co.uk>

**Disclaimer** This data sheet and its contents (the "Information") belong to the Premier Farnell Group (the "Group") or are licensed to it. No licence is granted for the use of it other than for information purposes in connection with the products to which it relates. No licence of any intellectual property rights is granted. The Information is subject to change without notice and replaces all data sheets previously supplied. The Information supplied is believed to be accurate but the Group assumes no responsibility for its accuracy or completeness, any error in or omission from it or for any use made of it. Users of this data sheet should check for themselves the Information and the suitability of the products for their purpose and not make any assumptions based on information included or omitted. Liability for loss or damage resulting from any reliance on the Information or use of it (including liability resulting from negligence or where the Group was aware of the possibility of such loss or damage arising) is excluded. This will not operate to limit or restrict the Group's liability for death or personal injury resulting from its negligence. Multicomp is the registered trademark of the Group. © Premier Farnell plc 2004.

