

*ROHS

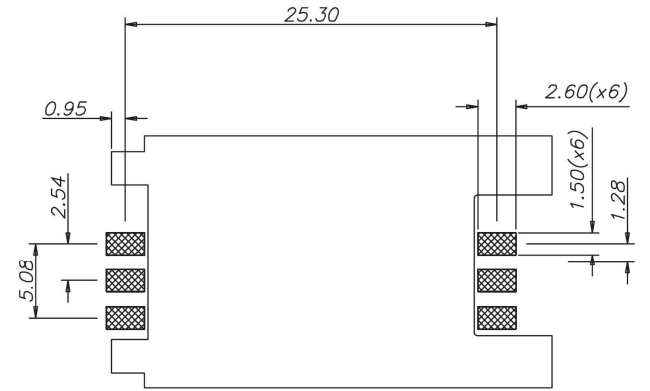
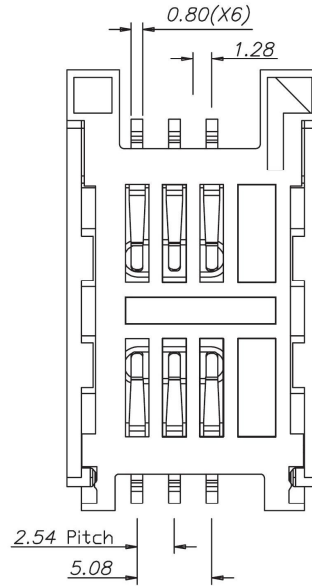
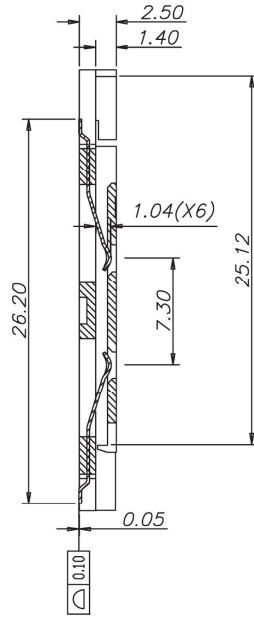
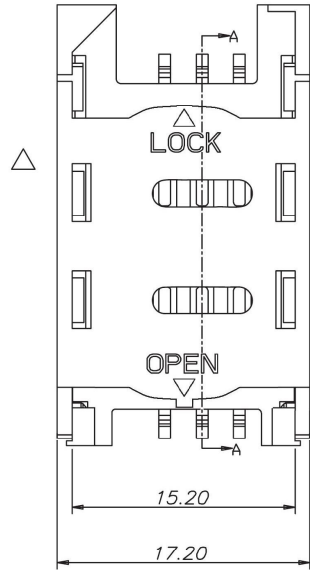
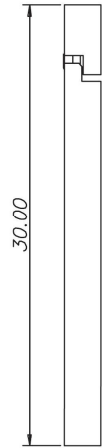

RECOMMEND PCB LAYOUT
TOLERANCE ± 0.05MM
TOP VIEW

A. Material:

1. Insulator: High temperature thermoplastic 9T UL94V-0, (BLACK)
2. Pho. Bronze: Plating, 50-80U" MIN NICKEL UNDERPLATED; 1-3U" GOLD ON THE CONTACT AREA; 80U" TIN PLATING ON SOLDER TAIL

B. Electrical specifications:

- Voltage rating: 12 V AC
- Current rating: 0.5A
- Dielectric strength: 500V AC for 1 minute min
- Insulation resistance: 1000 M ohm
- Contact resistance: 50 mill.ohm max
- Operation temperature: -40°C to +105°C
- Product withstanding rff low soldering 260°C for 10s

- C. Mechanical specifications:
- 3.1 Durability: 5000 cycles

SEC A-A

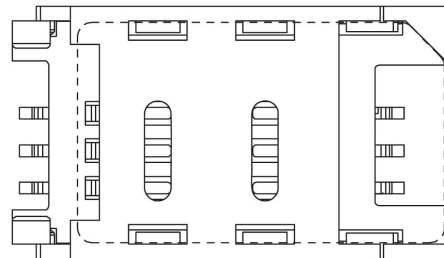
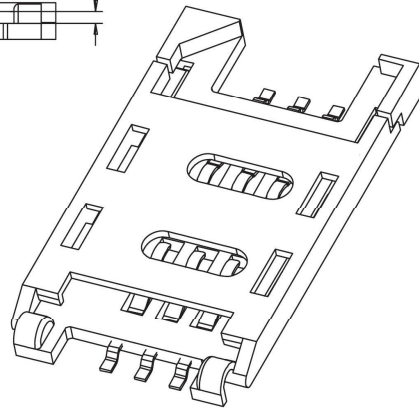
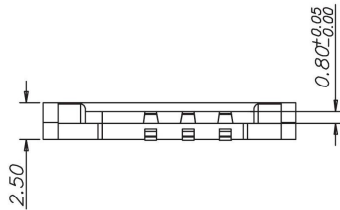

STATF OF LOCK

XYZHOVISMA06B

TOLERANCES		PROJECTION	TITLE		
x.	= ± ----	 UNIT mm	SIM Card Connector Hinge Type All Plastic		
x.x	= ± 0.38				
x.xx	= ± 0.25				
x.xxx	= ± 0.10				
DRAWN	COCO	DATE	2012/03/10	PART NO.	VI-SIMA-06-B
SCALE	1:1	SIZE	A4	SHEET	1/1 REV A

REVISION NO.	ECR NO.	DESCRIPTION	MARK	DATE
1				
2				
3				