

Dimensional & Ordering Information:

Circuits	Dimension mm	
	L1	L2
2	2.54	5.08
3	5.08	7.62
4	7.62	10.16
5	10.16	12.70
6	12.70	15.24
7	15.24	17.78
8	17.78	20.32
9	20.32	22.86
10	22.86	25.40
11	25.40	27.94
12	27.94	30.48
13	30.48	33.02
14	33.02	35.56
15	35.56	38.10
16	38.10	40.64
17	40.64	43.18
18	43.18	45.72
19	45.72	48.26
20	48.26	50.80
21	50.80	53.34
22	53.34	55.88
23	55.88	58.42
24	58.42	60.96
25	60.96	63.50
26	63.50	66.04
27	66.04	68.58
28	68.58	71.12
29	71.12	73.66
30	73.66	76.20
31	76.20	78.74
32	78.74	81.28
33	81.28	83.82
34	83.82	86.36
35	86.36	88.90
36	88.90	91.44
37	91.44	93.98
38	93.98	96.52
39	96.52	99.06
40	99.06	101.60

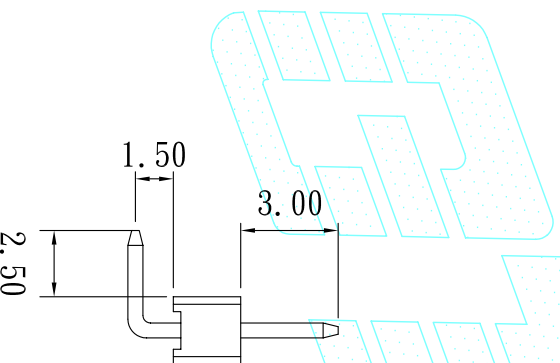
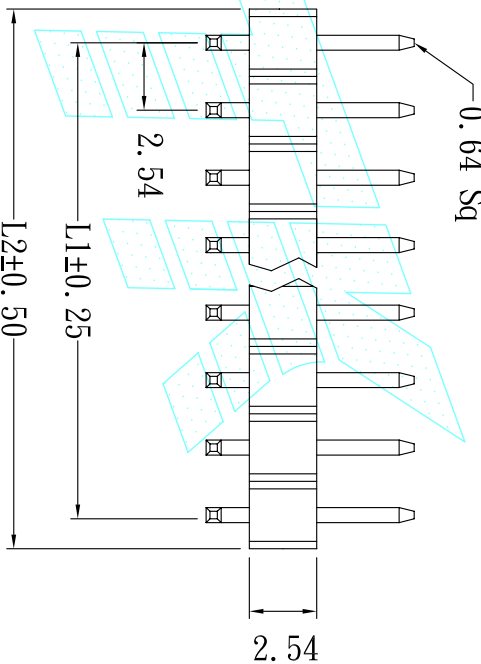
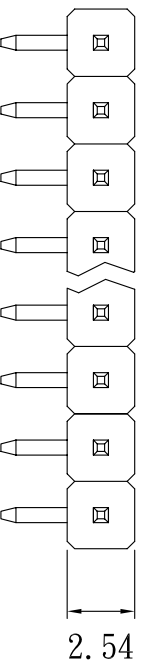
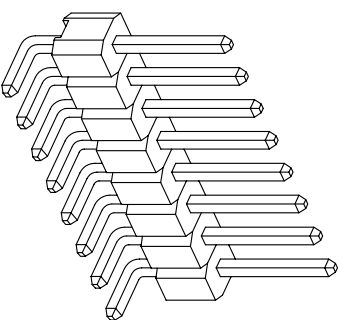

ROHS COMPLIANT

REV	ECN NO.	DESCRIPTION	DATE
A		RELEASE	OCT. 05' 06

SPECIFICATIONS

- Current Rating: 3 Amps
- Insulator resistance: 1000 Megohms Min.
- Dielectric withstanding: AC 500 V
- Operating Temperature: -40°C ~ +105°C
- Contact Material: Brass
- Insulator Material: P.B.T UL94V-0
- Finish: G:Gold flash

Recommended P.C.Board Hole Layout

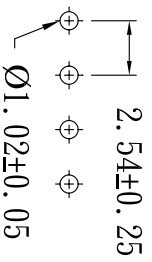

TOLERANCE UNLESS OTHERWISE SPECIFIED	PROJECTION
LINEAR	ANGLE
X ±	X° ±
X ± 0.38	X° ±
.XX ± 0.25	.XX° ±
.XXX ±	.XXX° ±
APPD	SCALE
CHKD	SIZE
DRAW	A4

GOLD-TEK ELECTRIC CO., LTD.



PART NO. PHSL\*\*G10/3/2.5/1.5/RH

CAD NO. 1642  
F:\Dtw\PH\PH-0309

SHEET 1 OF 1

圖面編號:GTKGS1509-A(1)