

SPECIFICATIONS

Current Rating: 3Amps
 Contact Resistance: 20m Ω Max
 Insulation Resistance: 1000M Ω Min
 Withstanding Voltage: 1000V AC for 1 minute
 Temperature Range: -40°C to +105°C
 Terminal : Copper Alloy
 Insulator: NY9T, UL94V-0

ORDER INFORMATION

M	R	25	85	X	7	-	1	XX
Right Angle Type	Height=5.0mm			NY9T	No. of Contacts			
Pitch 2.54mm					Single Row			
		G0:Gold Flash	S0:Selective Flash					
		G1:Gold 3u"	S1:Selective 3u"					
		G2:Gold 5u"	S2:Selective 5u"					
		G3:Gold 10u"	S3:Selective 10u"					
		G4:Gold 15u"	S4:Selective 15u"					
		G5:Gold 30u"	S5:Selective 30u"					

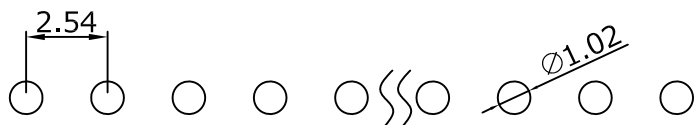
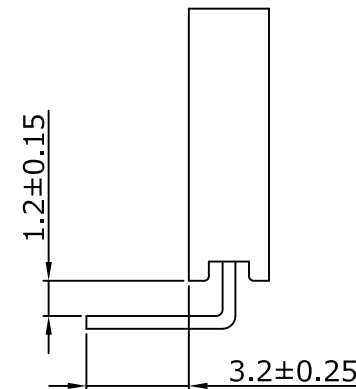
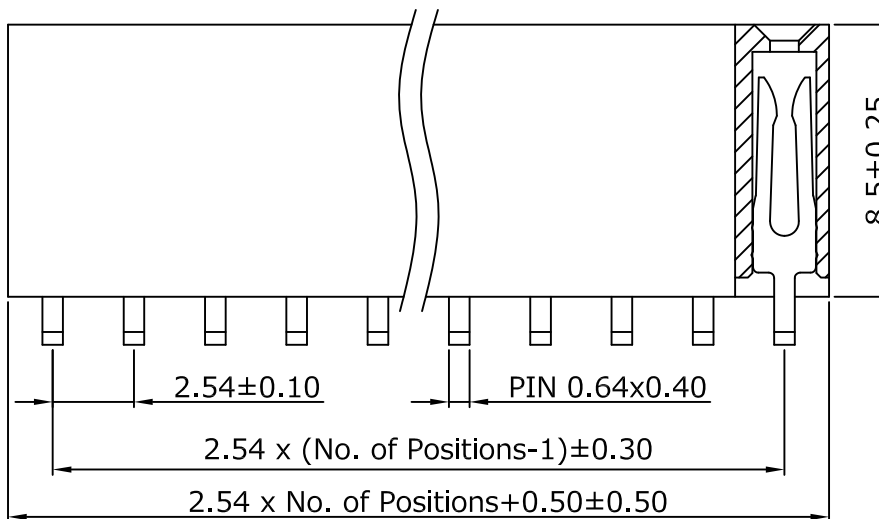
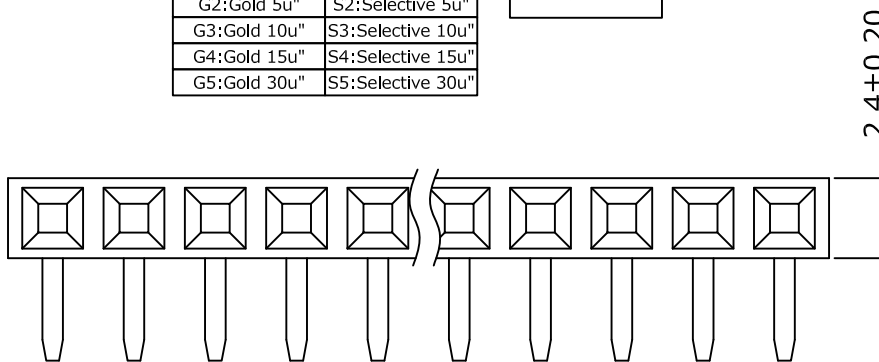

Recommended PCB Layout
 (PCB TOLERANCE ± 0.05)

M Morecrafts Technology
 TEL: +886-2-2966-1326
 FAX: +886-2-2966-1352
 www.morecrafts.com.tw

PART NO.	MR2585X7-1XX	DRAWN	Andrew
DRAWING NO.	MR2585X7-1XX	CHECKED	Claudia
DATE	2016/07/27	APPROVED	Brian

TITLE:	Female Header 2.54mm H=8.5mm	REV.	A0	TOLERANCE	.X ± 0.25 .XX ± 0.20	SCALE	1:1	UNIT	mm
--------	------------------------------	------	----	-----------	---------------------------------	-------	-----	------	----