



HIGH FREQUENCY ROD CHOKES TYPE MHR

[BACK TO INDEX](#)

VHF chokes of a ferrite rod, available as standard or P.C. board mount. Suitable for use in the frequency range from 30 to 200 Mhz.

These chokes are suitable for broadband interference suppression in electrical apparatus and appliances in the HF and VHF range, and to reduce the radiated interference from radio and TV receivers, Switch mode power supplies and appliances using brush motors.

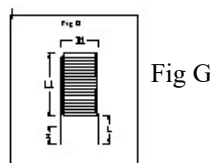
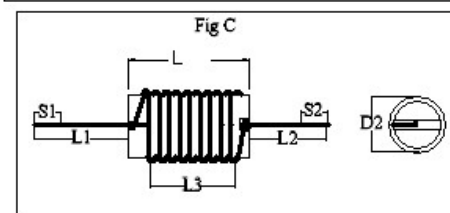
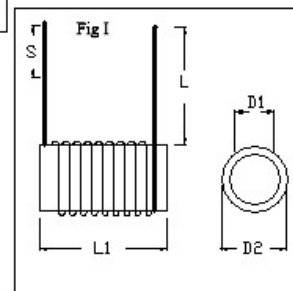
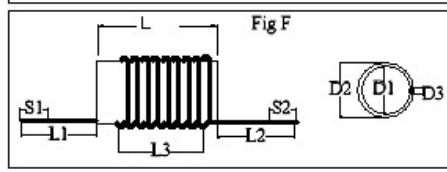
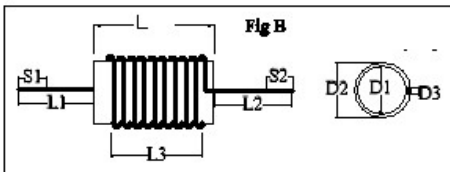
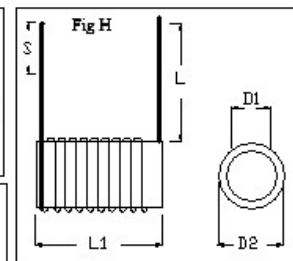
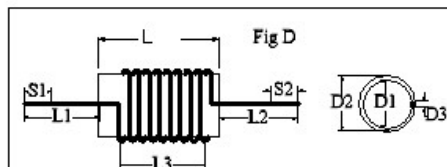
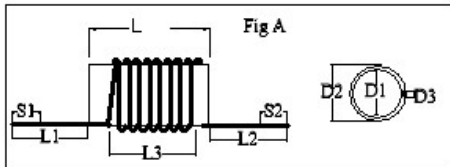



HIGH FREQUENCY ROD CHOKES TYPE MHR

[BACK TO INDEX](#)

VHF chokes of a ferrite rod, available as standard or P.C. board mount. Suitable for use in the frequency range from 30 to 200 Mhz.

These chokes are suitable for broadband interference suppression in electrical apparatus and appliances in the HF and VHF range, and to reduce the radiated interference from radio and TV receivers, Switch mode power supplies and appliances using brush motors.

Inductance (uh)	Rod	Test Freq	I dc (A)	Lead Wire Size (mm)	Figure	Diameter Max.	Stock Code	Remarks
18.2	6.35/19	1khz/S	2.5	0.5	G	9	40/367	
34	5/20	1khz/S	5	.63	I	7.5	40/981A	
34	5/20	1khz/S	5	.63	G	7.5	40/981	
7.0	6.35/19	1khz/S	7.5	.71	H	8	40/513	
8.0	6.35/19	1khz/S	7.5	.71	I	8	40/809	
5.4	6.35/19	1khz/S	10	1.0	G	11.5	40/390	
2.5	6.35/19	1khz/S	10	1.0	G	10	40/391	
5.1	6.35/19	1khz/S	15	1.18	G	9	40/003	
4.4	6.35/19	1khz/S	18	1.41	I	9	40/551	
3.0	5/20	1khz/S	22	1.6	A	8.5	40/012	
2.0	5/20	1khz/S	22	1.6	F	8.5	40/013	
2.4	5/20	1khz/S	22	1.6	D	8.5	40/006	
2.2	5/20	1khz/S	26	2.0	F	9.5	40/007	
1.9	6.35/19	1khz/S	30	2.6	A	11	40/008	
1.7	6.35/19	1khz/S	35	3.0	H	13	40/015	