

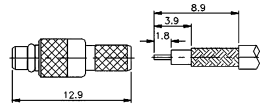

M52300
MMCX male crimp type
(RG174U/178U)
(gold plated)

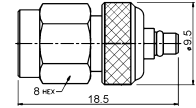

M52398
MMCX male to SMA male
(gold plated)



M52306
Right angle MMCX male crimp type
(RG174U/178U)
(gold plated)

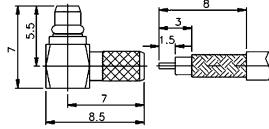

M52400
MMCX male to SMA female
(gold plated)

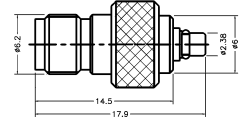

M52310
MMCX female crimp type
(RG174U/178U)
(gold plated)

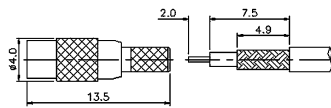

M52402
MMCX female to SMA male
(gold plated)

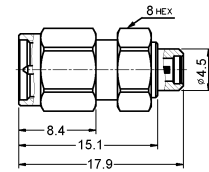

M52316
MMCX female bulkhead crimp type
(RG174U/178U)
(gold plated)

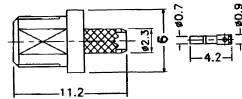

M52410
MMCX female to SMA female
(gold plated)

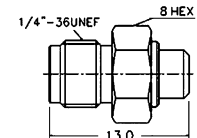

M52360
MMCX male PCB mount
(gold plated)

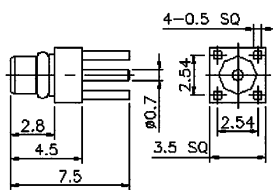
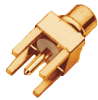

M52430
MMCX female bulkhead
(gold plated)

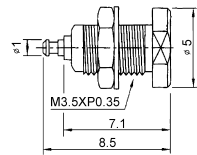

M52370
MMCX female PCB mount
(gold plated)

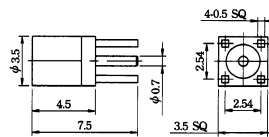

M52460
MMCX male solder type
for semi-rigid cable
(RG405U)
(gold plated)

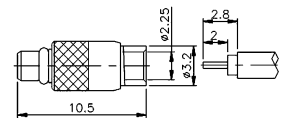

M52376
MMCX female PCB mount
(gold plated)

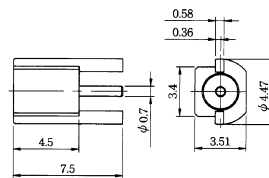

M52462
Right angle MMCX male solder type
for semi-rigid cable (RG405U)
(gold plated)

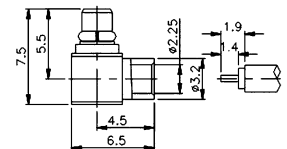

M52380
Right angle MMCX female PCB mount
(gold plated)

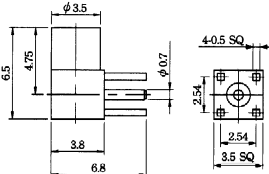

M52466
MMCX female solder type
for semi-rigid cable
(RG405U)
(gold plated)

