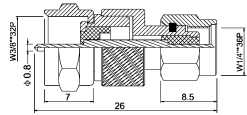
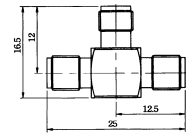
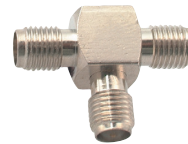

**M503450**

SMA male to F male gold-pin

**M5040**

T-type triple SMA female gold-pin

**M503451**

SMA male to F female gold-pin

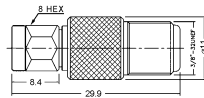
**M5041**

Protective cap for SMA female

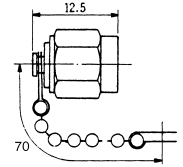
**M503452**

SMA female to F male gold-pin

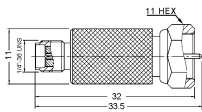
**M5042**

Protective cap for SMA male

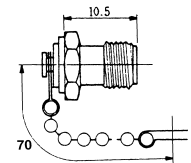
**M503453**

SMA female to F female gold-pin

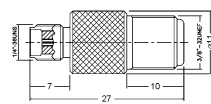
**M5043**

SMA female bulkhead gold-pin

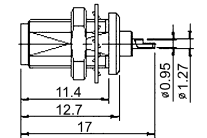
**M5035**

Double SMA female gold-pin

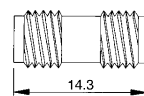
**M5050**

SMA male solder type for semi-rigid cable gold-pin (RG402U/405U)

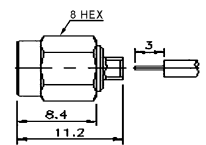
**M5036**

Double SMA female bulkhead gold-pin

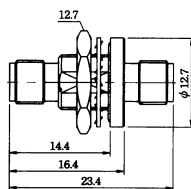
**M5051**

Right angle SMA male solder type for semi-rigid cable gold-pin (RG402U/405U)

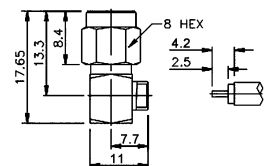
**M5037**

Right angle SMA male crimp type gold-pin (RG58U/174U)

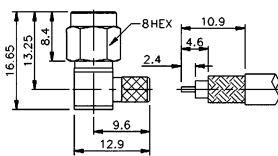
**M5052**

SMA female solder type for semi-rigid cable gold-pin (RG402U/405U)

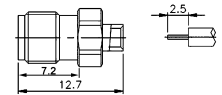
**M5038**

Right angle SMA male to female gold-pin

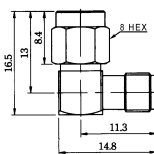
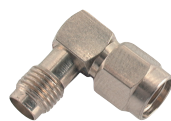
**M5053**

SMA female chassis mount gold-pin (RG402U/405U)

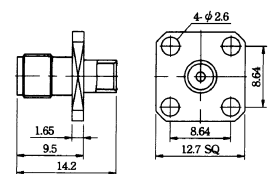
**M5039**

T-type SMA male to double female gold-pin

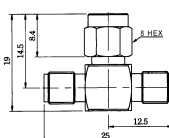
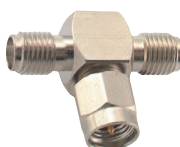
**M5054**

SMA female chassis mount gold-pin (RG402U/405U)

