

## CR2477

## Lithium Button Cell

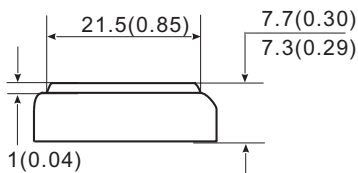

### Dimensions

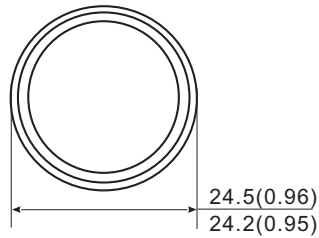

Unit:mm(inch)

### Specifications

<b>Chemical System:</b>	Lithium/Manganese Dioxide
<b>IEC Name:</b>	CR 2477
<b>Camelion Model:</b>	CR2477
<b>Average Weight:</b>	10.5g
<b>Dimension( Ø x H ):</b>	24.5 <sup>-0.3</sup> x7.7 <sup>-0.4</sup> mm 0.96 <sup>-0.01</sup> x0.30 <sup>-0.02</sup> inch
<b>Terminals:</b>	Flat
<b>Nominal Voltage:</b>	3.0Volts
<b>Capacity:</b>	1000mAh (Rated at 4.7kΩ to 2.00V)
<b>Standard Discharge Current:</b>	0.2mA
<b>Max. Continuous Discharge Current:</b>	0.5mA
<b>Max. Pulse Discharge Current:</b>	15.0mA
<b>Operating Temperature:</b>	-20°C-60°C
<b>Storage Temperature:</b>	18°C-28°C
<b>Relative Humidity:</b>	60±15%
<b>Cross Reference:</b>	E-CR2477(Energizer) DL2477(Duracell) KECR2477(Rayovac)

### Usage Guide



Calculator



Remote control



Electronic scales

### Cautions

#### Storage

Store the battery in a cool, dry and well-ventilated area.

#### Handling

- 1)Never charge the battery. Do not heat or disposed in fire or water. Do not modify or disassemble the battery.Do not short-circuit positive (+) and negative (-) terminals. Keep away from metal or other conductive materials.
- (2)Keep away from infants. If infant happens to swallow the battery, consult a doctor immediately.
- (3)When the battery is stored or disposed, isolate positive (+) and negative (-) terminals of the battery to avoid those terminals touch each other.
- (4)In case the battery electrolyte happen to come into mouth,gargle well enough and consult a doctor immediately.

#### Notice:

Environmental elements comply with RoHS requirements.This information is subject to change without prior notice and for reference only. It should not be used as a basis for a product guarantee or warranty . For additional information, please consult your nearest Camelion Sales Office or Distributor or visit our website at: [www.camelionbattery.com](http://www.camelionbattery.com).

**CR2477**

**Lithium Button Cell**

**Discharge Characteristics**

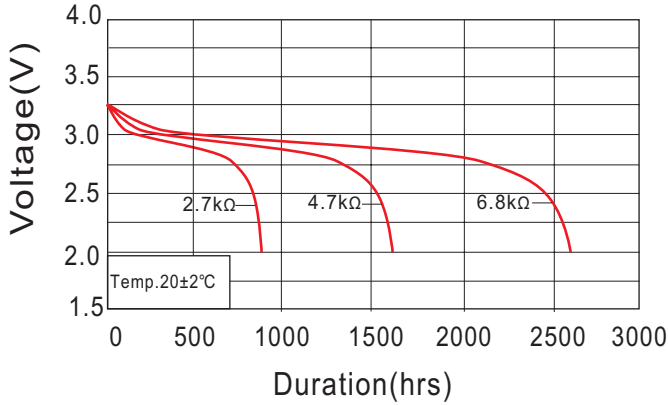

**Temperature Characteristics**

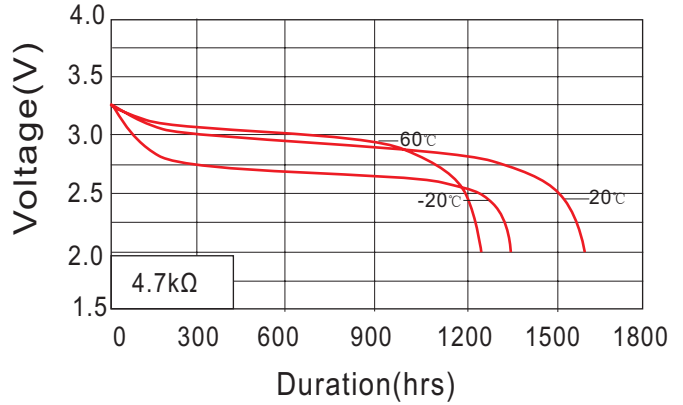

**Load-capacity Characteristic**

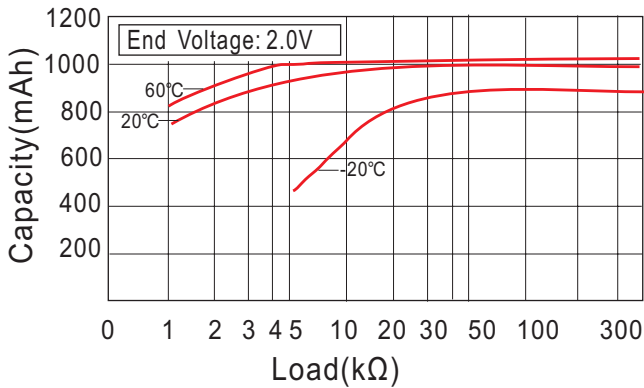

**Operating Voltage**

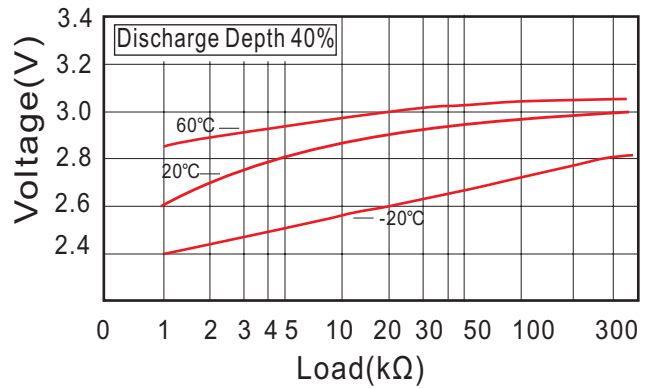

**Pulse Discharge Characteristic**

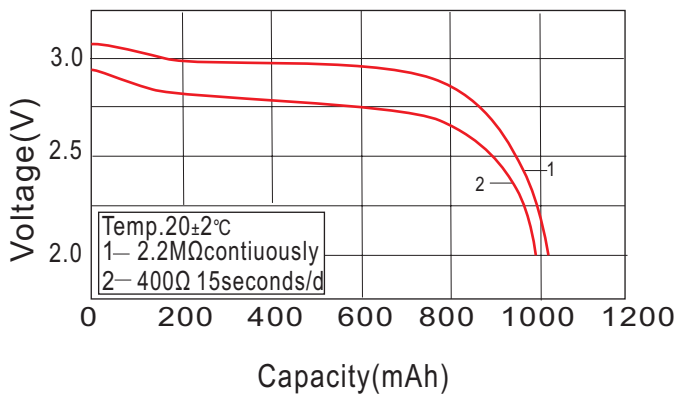

**Storage Characteristic**

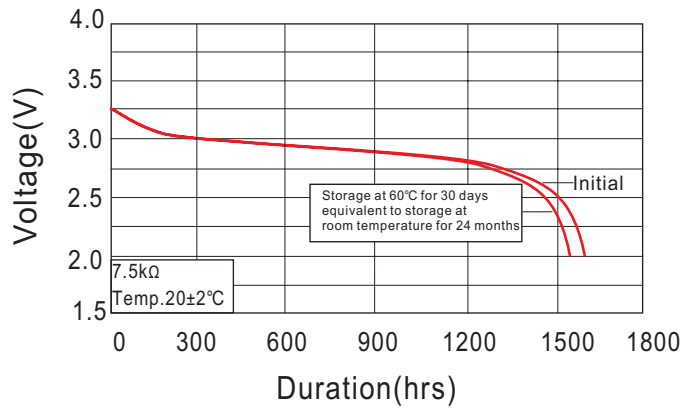

**Notice:**

Environmental elements comply with RoHS requirements. This information is subject to change without prior notice and for reference only. It should not be used as a basis for a product guarantee or warranty. For additional information, please consult your nearest Camelion Sales Office or Distributor or visit our website at: [www.camelionbattery.com](http://www.camelionbattery.com).