

| | | | |
|--|---------------------|---|-------------|
| Customer: 深圳高华 | | Part No: | |
| Product: Piezoelectric elements | | Sushin Part No: SS20T125125A | |
| 一、 Configuration | | | |
| Appearance and dimension: see the drawing | | | |
| Material | | Piezoelectric | |
| Configuration | | 1:plane√ | 2:discal |
| Electrode form | | A: fullness √ | B: feedback |
| Metal material | | T: brass √ G: stainless steel N: nickel | |
| 二、 Electrical specification | | 三、 mm | |
| Resonant frequency (kHz) | $F_s=4.2\pm 0.4$ | 1、 $D_1=15.0\pm 0.3$ | |
| Resonant impedance (Ω) | $R_r\leq 400\Omega$ | 2、 $D=20.0-0.1$ | |
| Capacitance at 1000Hz (PF) | $C_0=25000\pm 30\%$ | 3、 $H_1=0.125\pm 0.01$ | |
| Operating temperature ($^{\circ}\text{C}$) | -20 ~ +70 | 4、 $H=0.25\pm 0.03$ | |
| Storage temperature ($^{\circ}\text{C}$) | -30 ~ +80 | | |

APPEARANCE UNIT: mm

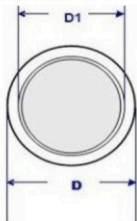

| | | |
|-----|----|-----|
| 批准 | 审核 | 制图 |
| 程泽修 | | 刘晓东 |