

1

2

3

4

5

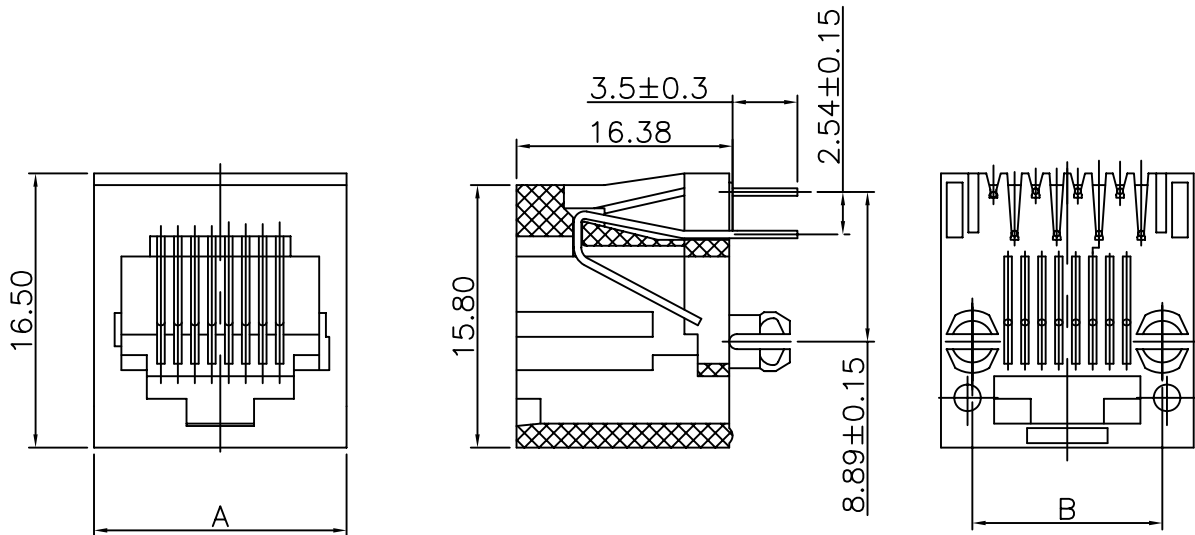

Specifications:

Current Rating:1.5A AC/DC  
 Voltage Rating:125V AC/DC  
 Contact Resistance:20m ohm Max.  
 Insulation Resistance:500 ohm Min.  
 Withstanding Voltage:1,000/minute  
 Temperature range:-40°C to +85°C

Material and Finish:

Insulator:PBT (UL94V-0),Black  
 Contact:Copper Alloy  
 Contact:Selective Gold Plated

How To Order

7006-XPXC-01-F1

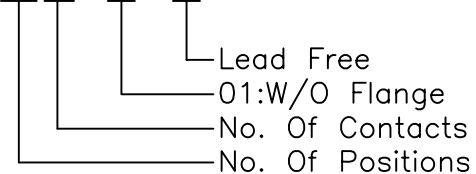

| Pos | CONTACT  | A     | B     |
|-----|----------|-------|-------|
| 4P  | 4C       | 11.43 | 7.62  |
| 6P  | 2C/4C/6C | 13.45 | 10.16 |
| 8P  | 8C       | 15.3  | 11.43 |

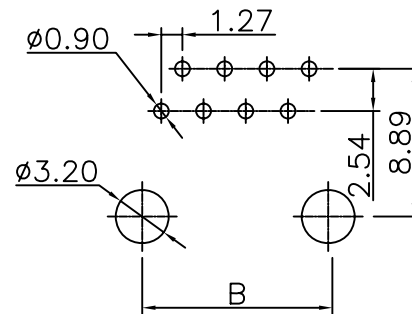

PCB Layout

RoHS Compliant

| REV | DATE        | FILE     | BY    |
|-----|-------------|----------|-------|
| A   | 13-May-2008 | (PC0162) | P.D.J |

|                        |
|------------------------|
| DRAWN:<br>P.D.J        |
| CHECKED:<br>Jeremy Liu |
| APPROVAL:<br>Mike Wu   |

|  |
|--|
| GENERAL TOLERANCE:<br>.X=±0.2<br>.XX=±0.15 |
| UNIT: mm                                   |
| SCALE:                                     |
| SHEET: 1 / 1                               |
| PROJECTION:                                |

|  |                   |
|--|-------------------|
| <b>繼德工業股份有限公司</b><br><b>Neltron Industrial Co., Ltd.</b>     |                   |
| DESCRIPTION:<br>Top Entry Split Pegs Round Contacts PCB Jack | SIZE<br><b>A4</b> |
| PART NO:<br>7006-XPXC-01-F1                                  |                   |

A

B

C

D