

# 三兴达微型电机有限公司

## 贝斯特(深圳)摩打厂

### 样品承认书

客户名称: 万宝刚

产品名称: \_\_\_\_\_

电机型号: SRC-365SA-15130-51

样品编号: 081127-4/80182

客户编号: SR365SA-15130-51

备注: \_\_\_\_\_

本司签章:

日期: 2008年12月1日

检查 TESTED BY	核对 CHECKED BY	承认 APPROVED BY
<u>阮秀明</u>	<u>/</u>	<u>黄莉 1/12-08</u>

客户承认签章:

检查 TESTED BY	核对 CHECKED BY	承认 APPROVED BY

**SRC-365SA-15130-51 抽样计划**

一般检验之水平 II 单次抽验允收标准 (AQL)

严重缺陷 (CRITICAL) =0

主要缺陷 (MAJOR) =1.0

次要缺陷 (MINOR) =4.0

**成品检验规范**

类别	序号	检验内容	检验方法	判定		
				CR	MA	MI
材质要求	1	零件材质不符合要求者		*		
测试环境	1	温度: 20°C ± 4°C	温度计			
	2	湿度: 65% ± 5%	湿度计			
安全要求	1	耐压: 500VAC 0.5mA 1S	耐压计	*		
马达空载运行3分钟后,测试性能	1	正常使用电压: 12.0 VDC	电压表	*		
	2	空载转速: 7650 ± 10% rpm	转速表		*	
	3	空载电流: 0.14A Max <small>1.08 1.20</small>	电流表		*	
	4	负载转速: 5750 ± 10% rpm	转速表		*	
	5	负载电流: 0.52A Max <small>1.44 1.95</small>	电流表		*	
	6	负载: 60×20mm 本厂模拟风叶	卡尺		*	
	7	噪音: ≤62 dBA (距马达30cm测试)	分贝仪			*
	8	振动: 无明显抖动、晃动	手感		*	
	9	火花等级: 1 1/4	目测		*	
	10	旋转方向: CCW (马达出力轴向身)	手感		*	
外观尺寸要求	1	外形及安装尺寸需符合图纸要求(见附图)	治具		*	
	2	轴弯: ≤0.01mm	治具			*
	3	螺孔: M2.6*0.45	治具		*	
	4	轴伸尺寸: 15.5 ± 0.5mm	卡尺			*
	5	虚位: 0.05~0.50mm	治具			*
	6	标签纸: 依客户要求	目测			*
包装要求	1	包装: 放置、整齐、平稳、外箱包装完好	目测			*
	2	箱唛: 依客户要求	目测			*

DIRECTION OF ROTATION

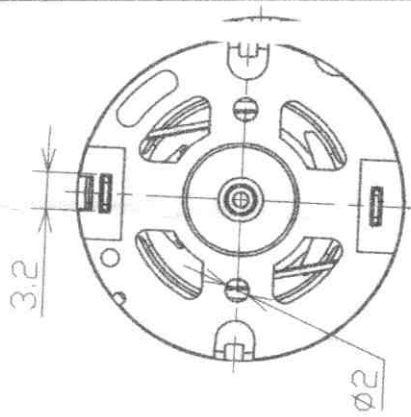
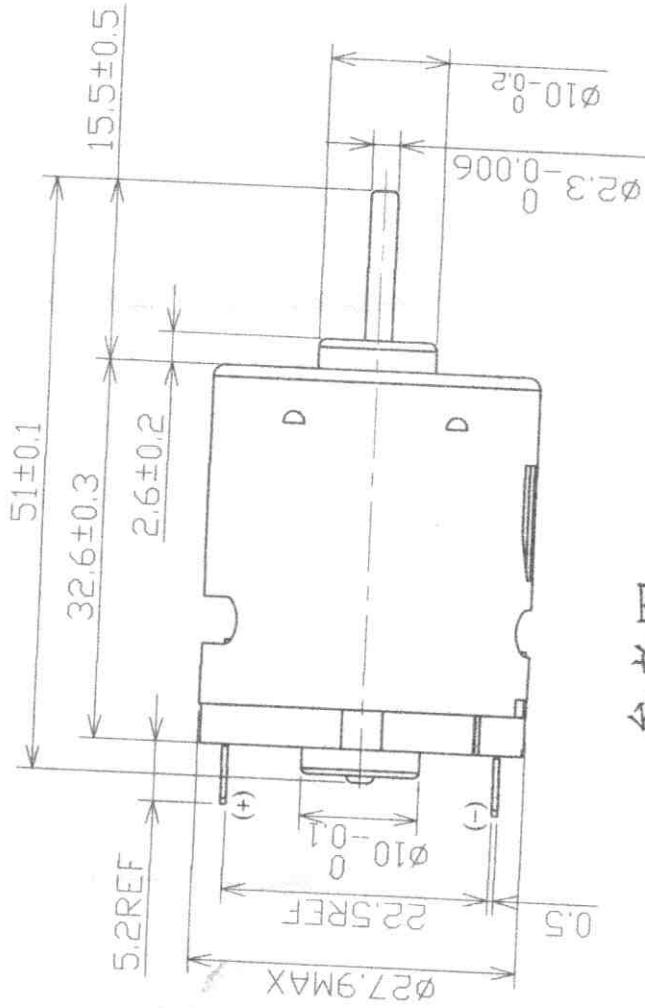
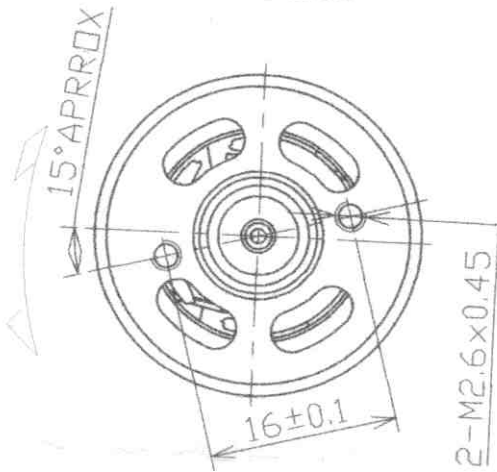

参考图:

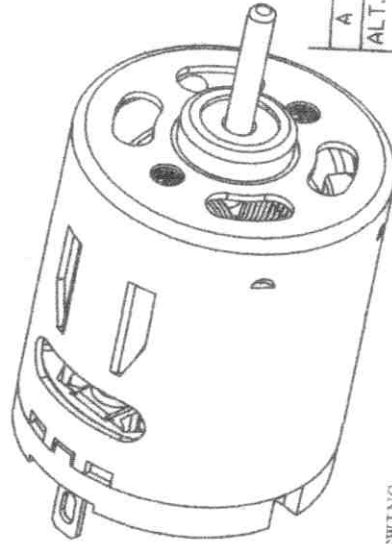

NOTES:

1. END PLAY 0.50mm MAX.
2. DIRECTION OF ROTATION: ANTI-CLOCKWISE WHEN VIEWING MOTOR OUTPUT END WITH POSITIVE VOLTAGE APPLIED TO POSITIVE TERMINAL.
3. FRONT EXTENSION IS MEASURED WITH SHAFT PUSHED TO PLASTIC END CAP.
4. OPERATING TEMPERATURE RANGE: -10° C --- 60° C
5. WEIGHT:

A	FIRST ISSUE	黄莉	07
ALT. REF.	DESCRIPTION	BY	
MATERIAL	FINISH	TOLERANCES 1 DEC PLACES ± 0.2 2 DEC PLACES ± 0.10 3 DEC PLACES ± 0.05 ANGULAR ± 2°	
TITLE			
MOTOR OUTLINE			
SCALE		DVN. BY	黄莉
		CHK. BY	
		APP. BY	
		DWG. NO.	

三兴达 MOTOR



三兴达微型电机有限公司  
贝斯特 (深圳) 摩打厂

Graph drawing

No. : 081127-4/80182

Date: 2008-12-1

Model: SRC-365SA-15130-51

— Efficiency

----- Power output

r	P	I	N
75	6.0	2.4	15000
50	4.0	1.6	10000
25	2.0	0.8	5000
0	0	0	0

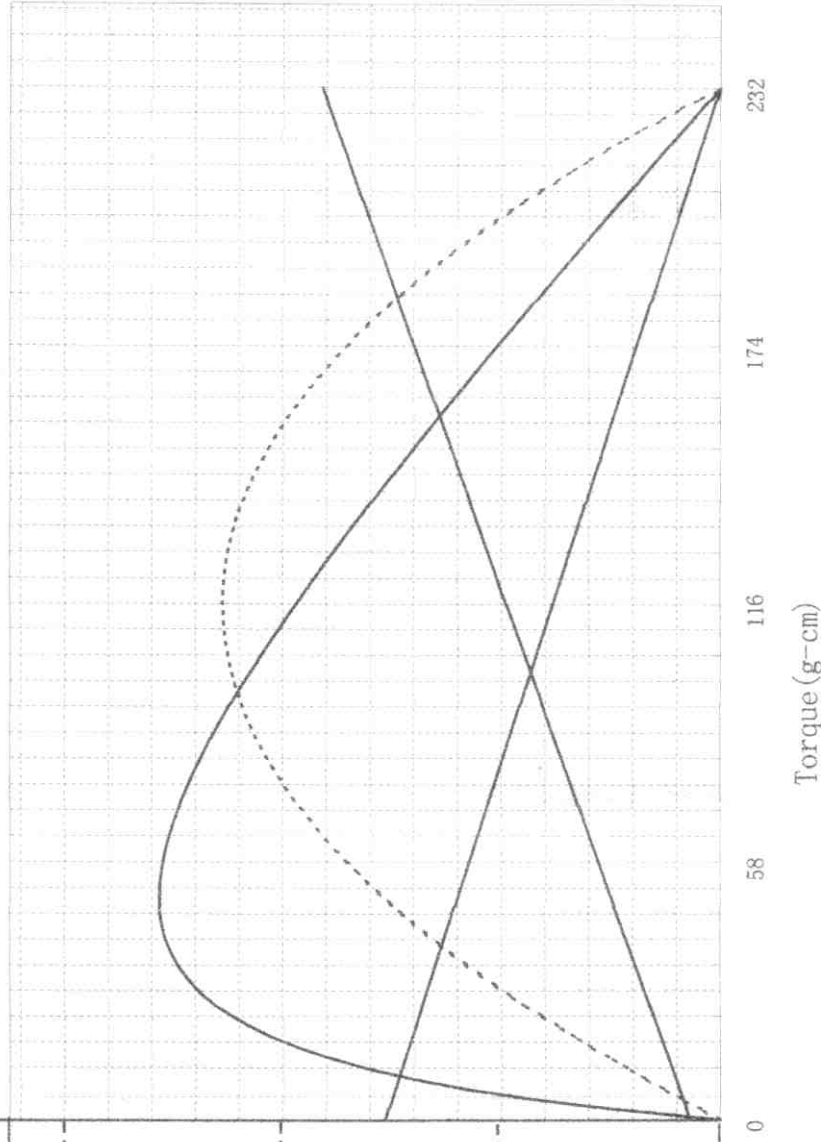

NOTE: Performance (in an ambient temperature of 25-30 °C)  
Motor tested rapidly to prevent significant temperature rise.

Constant voltage : 12.0 V  
Direction: CCW

At No Load  
Speed: 7650 RPM  
Current: 0.11 AMPS

At stall (Extrapolated)  
Torque: 231.8 ngf-cf  
Current: 1.45 AMPS

At maximum efficiency  
Efficiency: 64.1 %  
Torque: 51.0 ngf-cf  
Speed: 5967 RPM

At maximum Power output  
Current: 0.41 AMPS  
Output: 3.12 sWatt

Output: 4.55 sWatt  
Torque: 115.9 ngf-cf  
Speed: 3825 RPM

Current: 0.78 AMPS

Issued by QA Reliability Testing Center

COMPUTER PRINT-OUT  
NOMINAL MOTOR CURVES  
Performance and characteristics are measured based on limited motor samples only

(NOTE: 1mN-m = 10.2g-cm)