

BNC Connectors

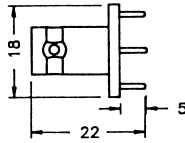

M55778
BNC FEMALE PCB MOUNT



M55791
RIGHT ANGLE BNC MALE TO
DOUBLE BNC FEMALE

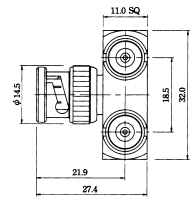
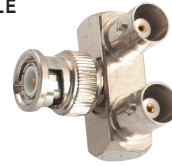

M55779
RIGHT ANGLE BNC FEMALE PCB MOUNT

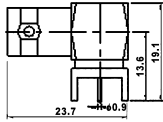
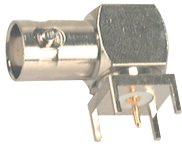

M55792
BNC MALE TO
DOUBLE BNC FEMALE

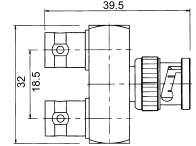
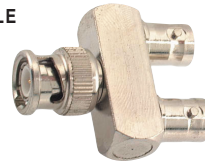

M55780
DOUBLE BNC FEMALE BULKHEAD
(ISOLATED GROUND)

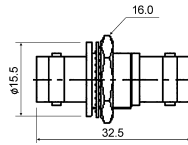

M55793
RIGHT ANGLE BNC MALE TO
DOUBLE BNC FEMALE

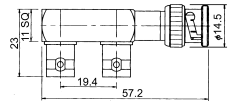
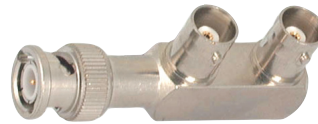

M55781
PROTECTIVE CAP FOR BNC FEMALE

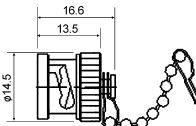

M55798
RIGHT ANGLE BNC MALE TO
TNC FEMALE

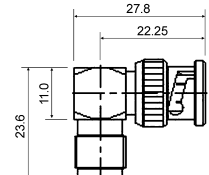

M55782
PROTECTIVE CAP FOR BNC MALE

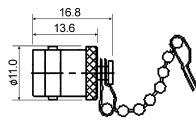

M55799
RIGHT ANGLE BNC MALE TWIST ON TYPE
(RG58U/59U)

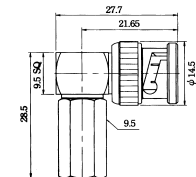

M55783
BNC MALE TERMINATOR
A: 50 Ω
B: 75 Ω
C: 93

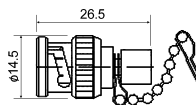

M557990
BNC MALE TO BNC FEMALE

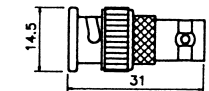

M55784
BNC FEMALE TERMINATOR
A: 50 Ω
B: 75 Ω
C: 93

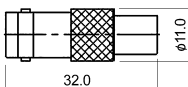

M557994
BNC MALE SCREW TYPE

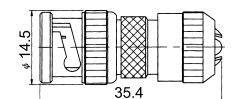

M55785
BNC FEMALE TO RCA FEMALE

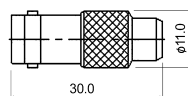
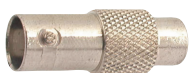

M55800
TWIN BNC MALE CRIMP TYPE
(RG108AU)

TWIN

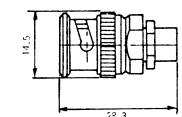

M55786
BNC FEMALE QUICK CRIMP TYPE
(RG58U/59U)

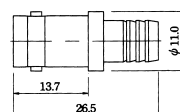

M55803
TWIN BNC FEMALE BULKHEAD

TWIN

