

Recommended
Mounting Holes
Dia 1.75-1.8x4 Holes

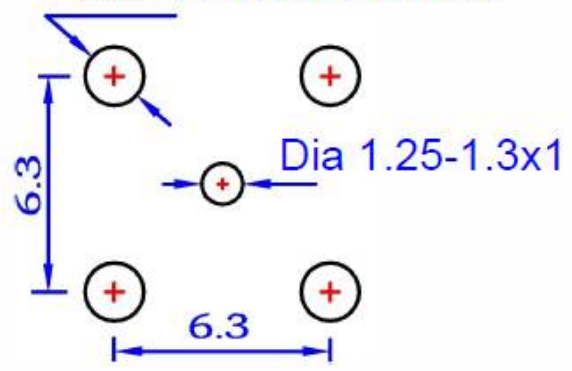

					UNITS	m/m	DRAWN		
3	PIN	BRASS	GOLD		<small>Unless Otherwise Specified</small> Tolerances ANGLES = ±3 UP TO 6 = ±0.1 6-40 = ±0.2 40-120 = ±0.6 120-315 = ±1.0 ABOVE 315 = ±1.6			CHECKED	TITLE.
2	INSULATOR	TEFLON			SCALE	5/1	APPROVED	PART NO. M5570T	
1	BODY	BRASS	NICKEL		ISSUE	A	DATE	File No.	
NO	DESCRIPTION	MATERIAL	FINISH	Q'TY	DRAWING NO.		97/04/17		