



Professional  
to  
create high-quality switches  
专业缔造高品质开关产品

Rocker Switch

船型开关



[www.chinadaier.com](http://www.chinadaier.com)





WPC-1510

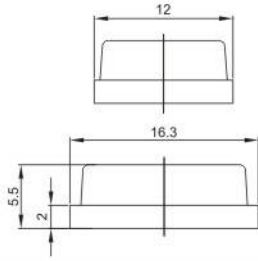

KCD5-303-1 SPST  
KCD5-303-2 DPST

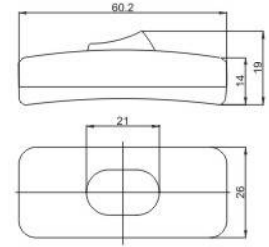

KCD5-2-101 ON-OFF

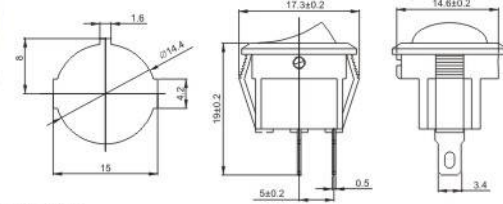

KCD5-304

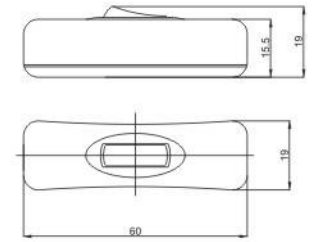

KCD5-2-102 ON-ON

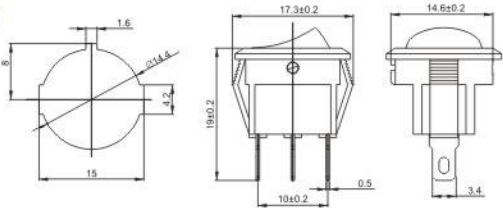

8S.304

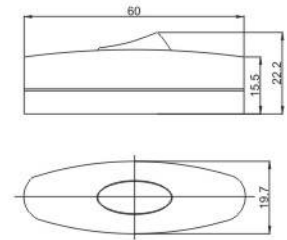

KCD5-2-101N ON-OFF

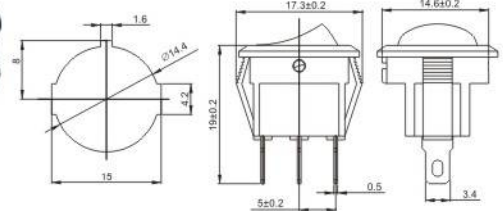

KCD5-305

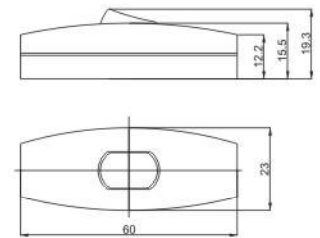

WPC-16

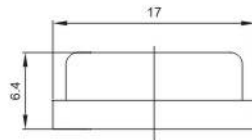

KCD5-322

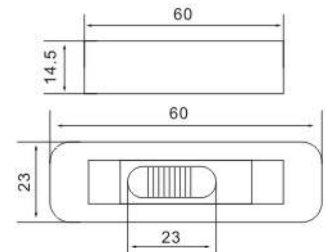

KCD5-3-101 ON-OFF

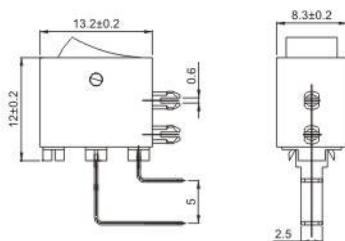

KCD5-307

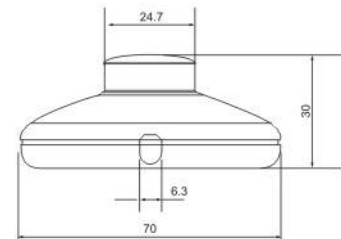

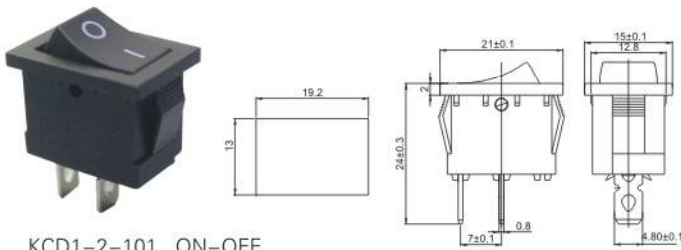

KCD1-2-101 ON-OFF  
KCD1-2-111 OFF-(ON)

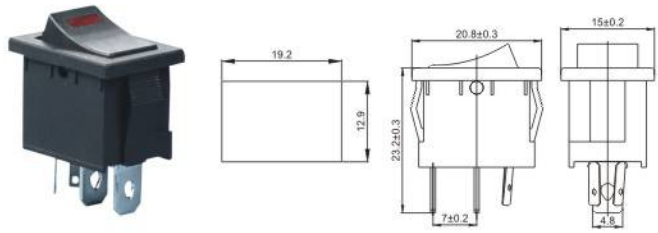

KCD1-3-101EN ON-OFF (3V LED)

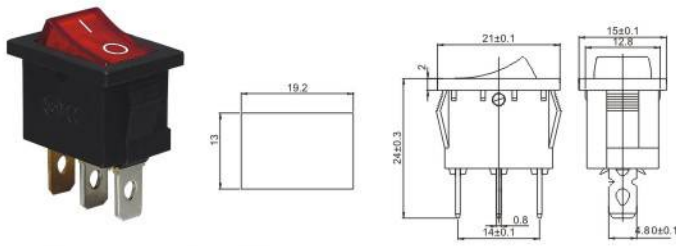

KCD1-2-101N ON-OFF

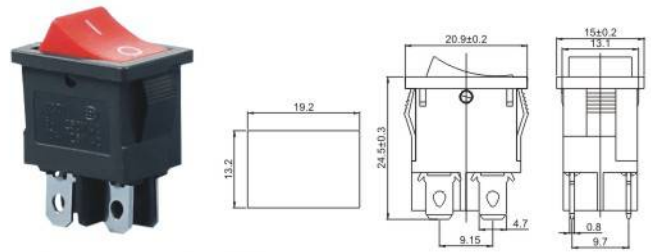

KCD1-4-201 ON-OFF

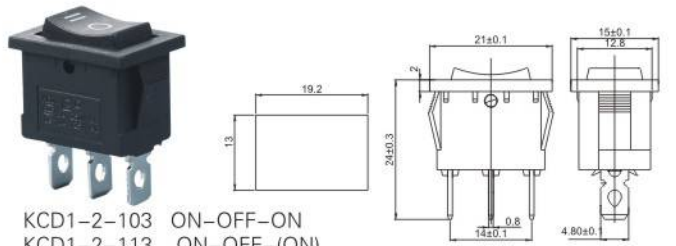

KCD1-2-103 ON-OFF-ON  
KCD1-2-113 ON-OFF-(ON)  
KCD1-2-123 (ON)-OFF-(ON)

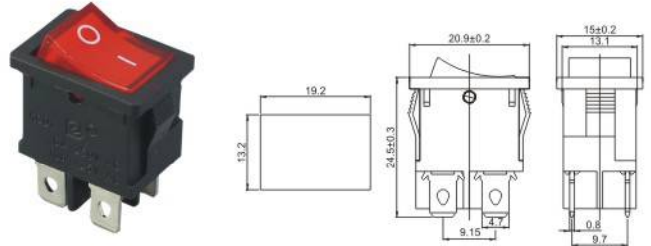

KCD1-4-201N ON-OFF

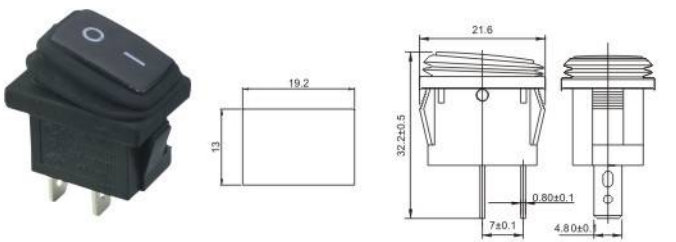

KCD1-2-101W ON-OFF

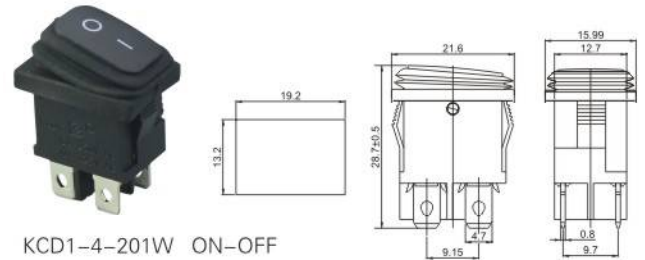

KCD1-4-201W ON-OFF  
KCD1-4-201NW ON-OFF

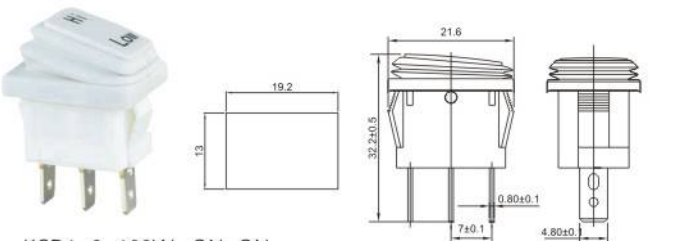

KCD1-2-102W ON-ON  
KCD1-2-103W ON-OFF-ON

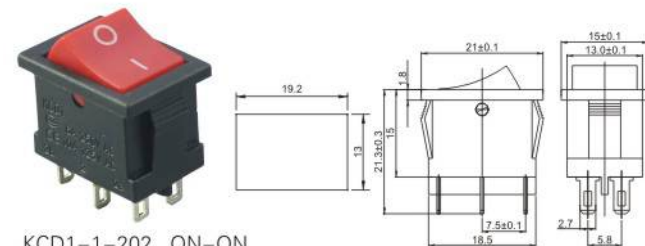

KCD1-1-202 ON-ON  
KCD1-1-203 ON-OFF-ON

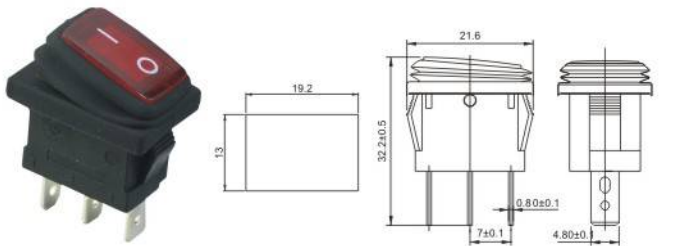

KCD1-2-101NW ON-OFF

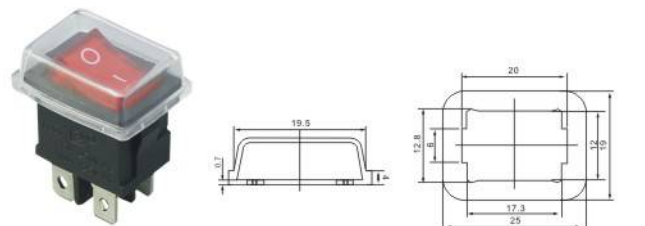

WPC-01

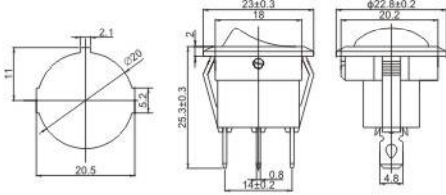

KCD1-8-101N ON-OFF

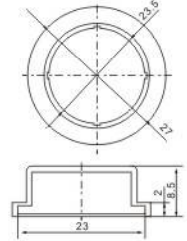

WPC-02

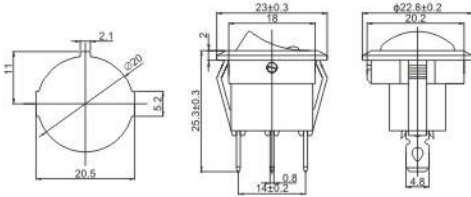

KCD1-8-101EN ON-OFF

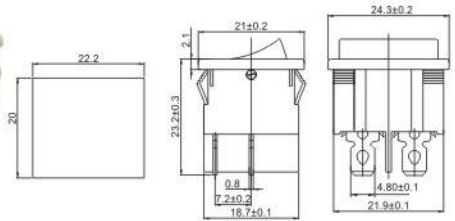

KCD1-6-201 ON-OFF

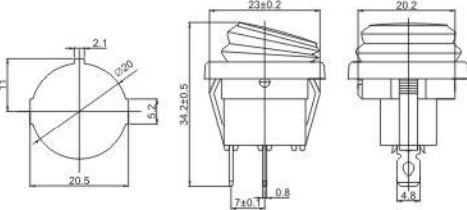

KCD1-8-101W ON-OFF

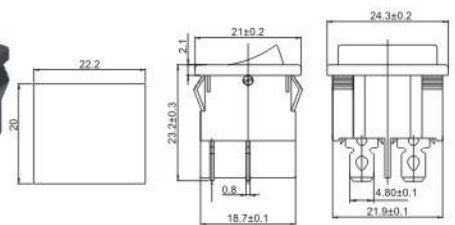

KCD1-6-201N ON-OFF

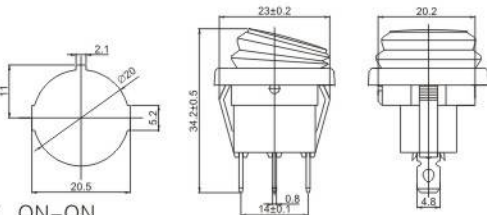

KCD1-8-102W ON-ON  
KCD1-8-103W ON-OFF-ON

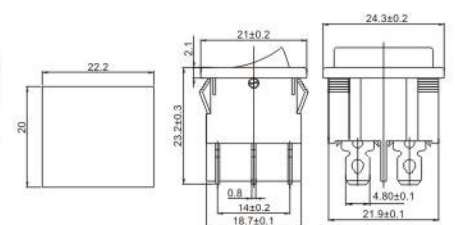

KCD1-6-202 ON-ON  
KCD1-6-202N ON-ON KCD1-6-203 ON-OFF-ON

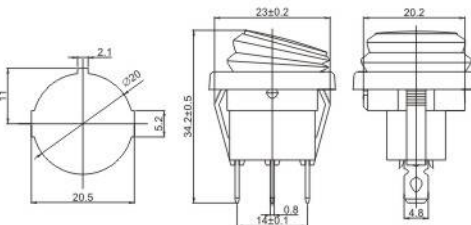

KCD1-8-101NW ON-OFF

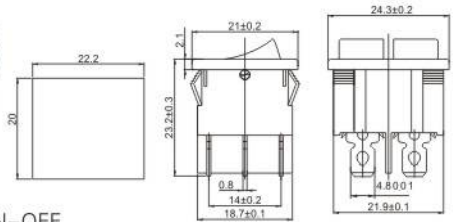

KCD1-6-2101 ON-OFF  
KCD1-6-2101N ON-OFF KCD1-6-2102 ON-ON

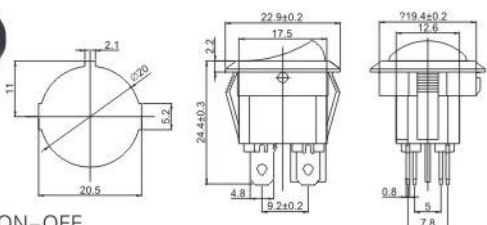

KCD1-8-201 ON-OFF  
KCD1-8-201N ON-OFF

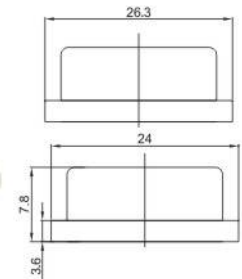

WPC-15

## KCD3 Series Rocker Switch

### 技术特性 Specification

- |   |   |
|---|---|
| 1. 规格 Rating: 20A 125VAC; 15A 250VAC            | 4. 耐电压 Dielectric Strength: 1500VAC, 1 Minute |
| 2. 接触电阻 Contact Resistance: 35mΩ max            | 5. 操作温度 Operating Temperature: -25°C~ +85°C   |
| 3. 绝缘电阻 Insulation Resistance: 500VDC 100MΩ min | 6. 电气寿命 Electrical Life: ≥10,000 Cycles       |

### 型号说明 Model Information

|            |   |          |   |          |  |  |   |  |  |  |   |          |                        |                       |          |                  |
|------------|---|----------|---|----------|--|--|---|--|--|--|---|----------|------------------------|-----------------------|----------|------------------|
| <b>KCD</b> | <b>3</b>  | <b>-</b> | <b>2</b>  | <b>-</b> | <b>1</b>   | <b>01</b>  | <b>N</b>  | <b>W</b>   | <b>L</b>   | <b>-</b>   | <b>C3</b>                                     | <b>-</b> | <b>R</b>               | <b>B</b>              | <b>-</b> | <b>220V</b>      |
|            | 特征<br>Features  |          | 序号<br>Series  |          | 刀数<br>Poles  | 功能<br>Function   | 带灯状态<br>Lamp  | 按钮类型<br>Actuator   | 端子类型<br>Terminals  |  | 标记<br>Marking                                 |          | 按钮颜色<br>Actuator Color | 外壳颜色<br>Housing Color |          | 灯电压<br>Lamp Volt |
|            | 1 Miniature<br>2 Medium 2 poles<br>3 Medium 1 pole<br>5 Sub-Miniature |          | 1 1 pole 1 button<br>2 2 pole 1 button<br>21 2 pole 2 button<br>3 3 pole 1 button<br>31 3 pole 3 button |          | 01 ON-OFF<br>02 ON-ON<br>03 ON-OFF-ON<br>11 (ONI)-OFF(单复位)<br>12 (ONI)-ON(单复位)<br>13 (ONI)-OFF-ON(双复位)<br>23 (ONI)-OFF-ON(双复位) | No Mark No lamp<br>N Lens illuminated<br>EN Dot illuminated<br><br>No Mark C shape<br>W Waterproof<br>H High Actuator<br>V V shape | No Mark Straight<br>D Short<br>L Right Angle<br>S Screw<br>T Through hole | C1<br>C2<br>C3<br>C4<br>C5<br>C6<br>C7<br>C8<br>C9<br>C10<br>CX 其他规格 | W 白色White<br>R 红色Red<br>G 绿色Green<br>Y 黄色Yellow<br>BL 蓝色Blue<br>O 橙色Orange<br>GR 灰色Gray<br>C 咖啡色Coffee | W 白色White<br>R 红色Red<br>G 绿色Green<br>Y 黄色Yellow<br>BL 蓝色Blue<br>O 橙色Orange<br>GR 灰色Gray<br>C 咖啡色Coffee | 3V<br>6V<br>12V<br>24V<br>48V<br>110V<br>220V |          |                        |                       |          |                  |

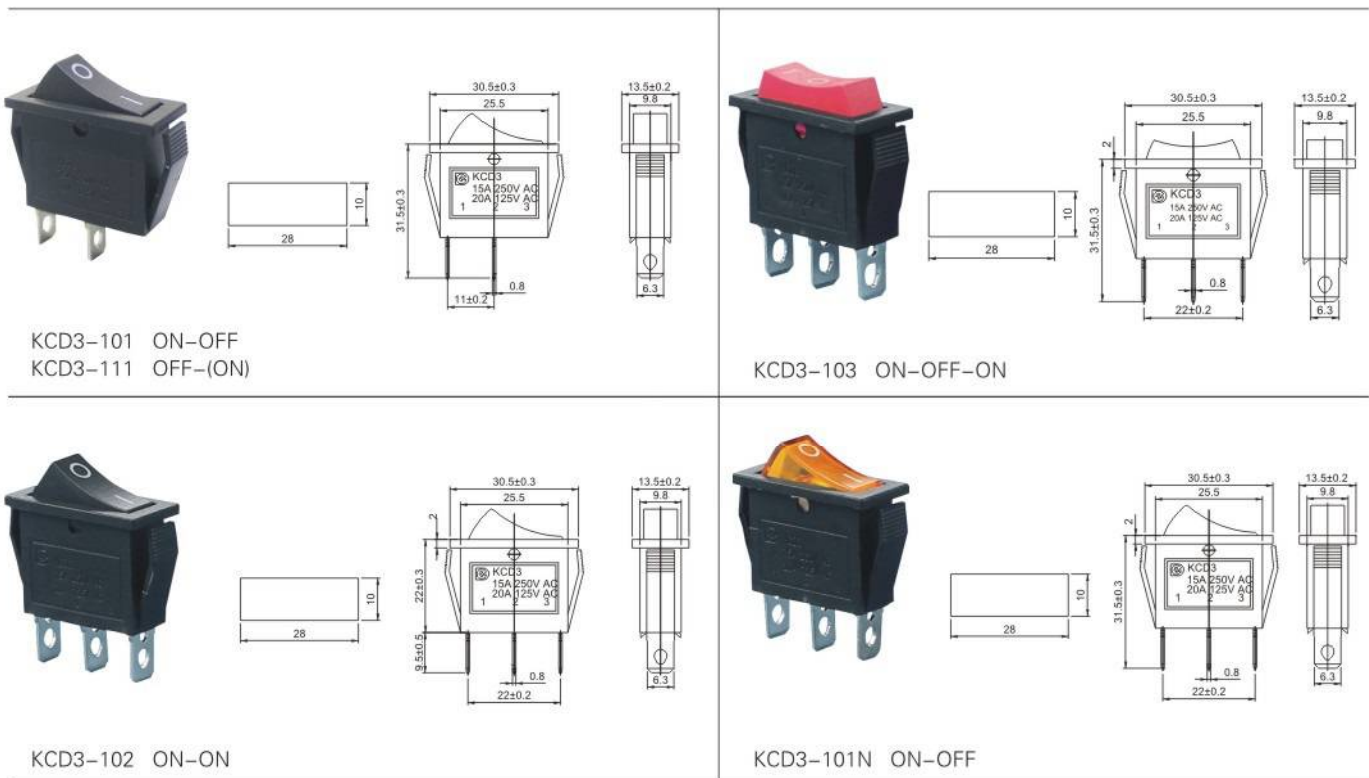

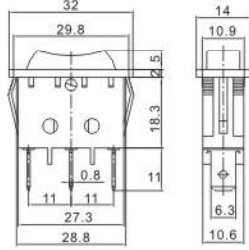
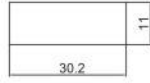

KCD3-4-103 ON-OFF-ON  
KCD3-4-123 (ON)-OFF-(ON)

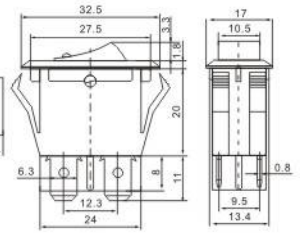

KCD3-11-201EN ON-OFF

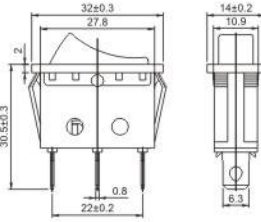
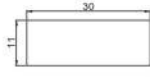

KCD3-4-101N ON-OFF

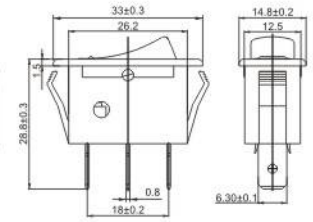
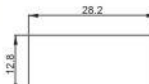

KCD3-12-101N ON-OFF

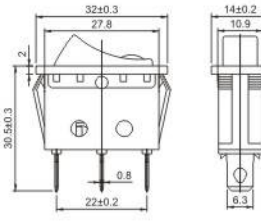
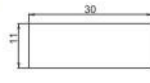

KCD3-4-101EN ON-OFF

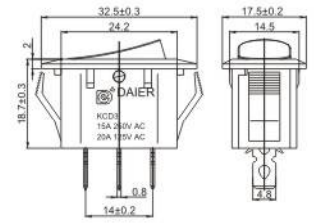
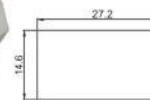

KCD3-18-101N ON-OFF

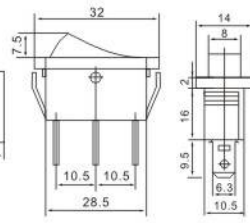

KCD3-5-101N ON-OFF

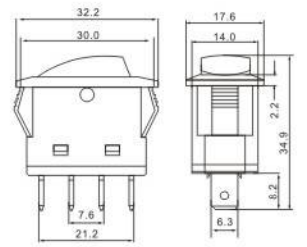
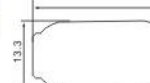

KCD3-14-201N ON-OFF

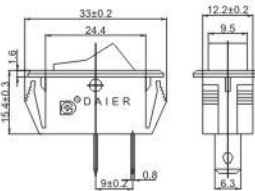

KCD6-101 ON-OFF

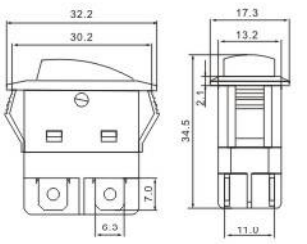
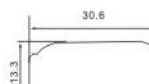

KCD3-14P-201N ON-OFF

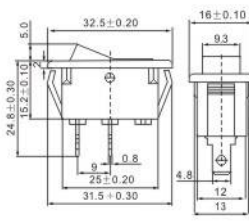

KCD3-8-101 ON-OFF  
KCD3-8-102 ON-ON

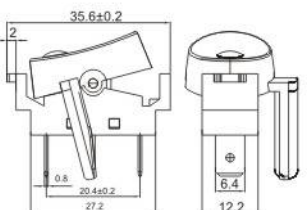
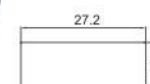

KCD3-17-101EN ON-OFF

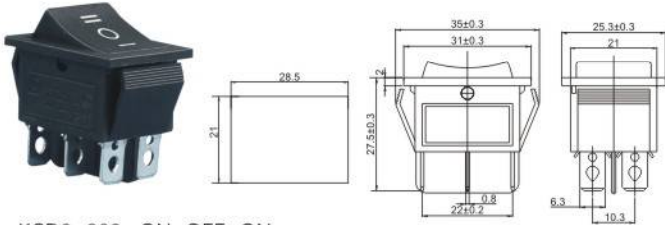

KCD2-203 ON-OFF-ON  
KCD2-213 ON-OFF-(ON) KCD2-223 (ON)-OFF-(ON)

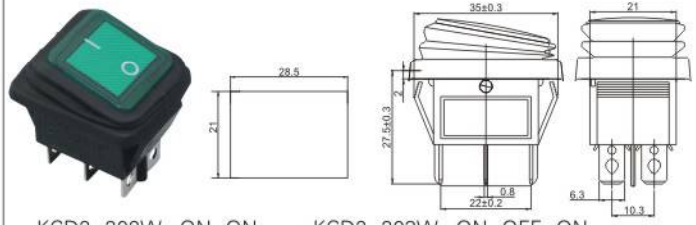

KCD2-202W ON-ON KCD2-203W ON-OFF-ON  
KCD2-202NW ON-ON KCD2-203NW ON-OFF-ON

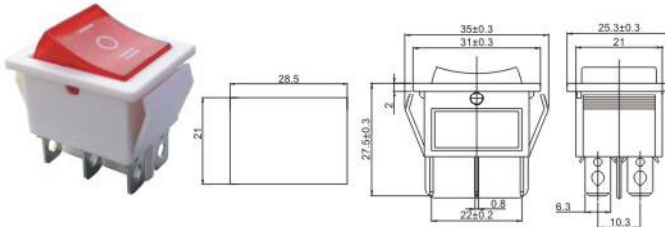

KCD2-203N ON-OFF-ON

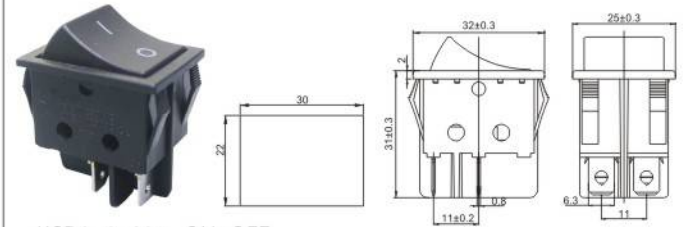

KCD2-2-201 ON-OFF  
KCD2-2-211 OFF-(ON)

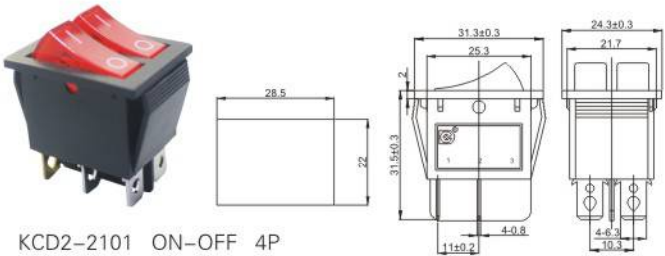

KCD2-2101 ON-OFF 4P  
KCD2-2101N ON-OFF 6P

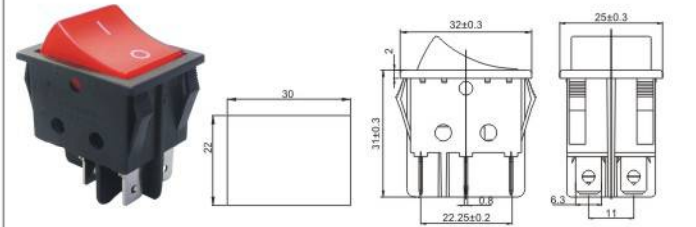

KCD2-2-201N ON-OFF

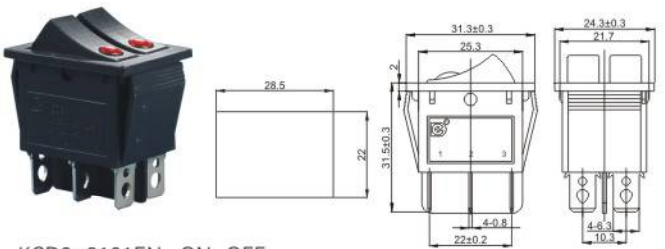

KCD2-2101EN ON-OFF

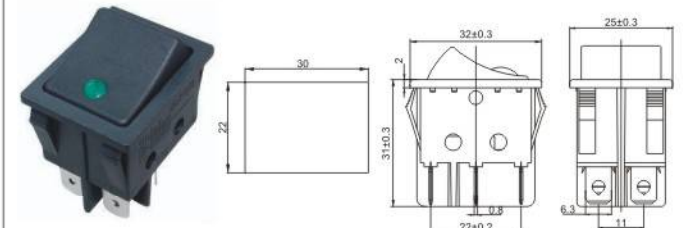

KCD2-2-201EN ON-OFF

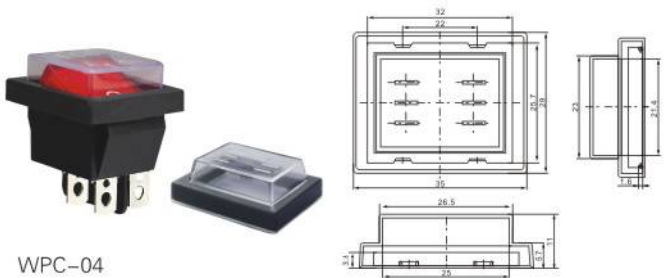

WPC-04

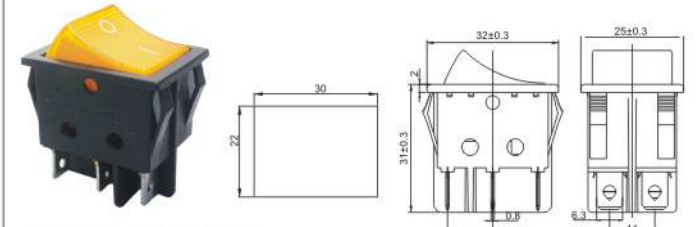

KCD2-2-202 ON-ON  
KCD2-2-202N ON-ON

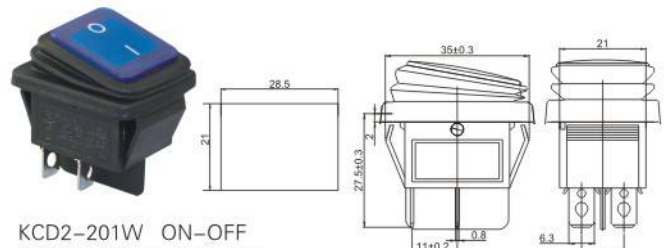

KCD2-201W ON-OFF  
KCD2-201NW ON-OFF

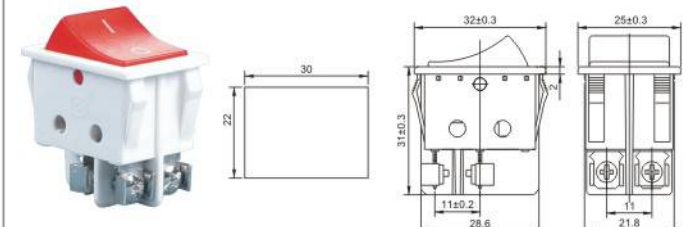

KCD2-2-201NS ON-OFF