

# GMP42-TEC4260-1250-14 MOTOR

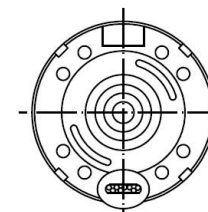
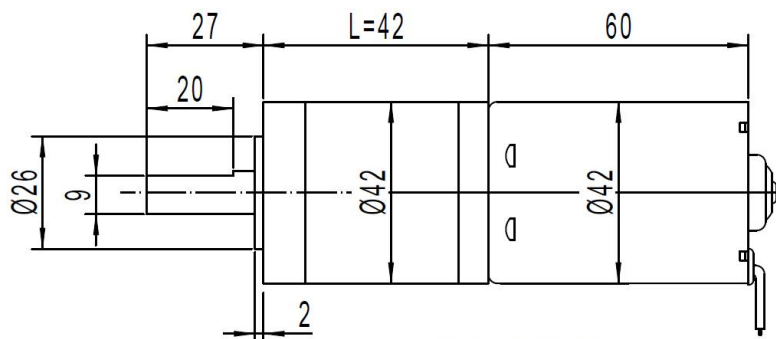
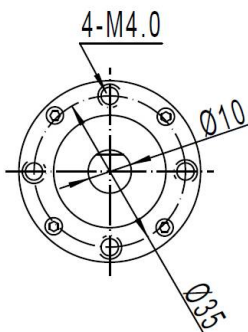

### MOTOR Specification(For Reference):

Operating voltage: 12.0V DC

- 1、 No Load Speed:360±12%rpm
- 2、 No Load Current:0.45A( 0.55A max)
- 3、 Rated Torque:5kg. cm
- 4、 Rated Speed:290±12%rpm
- 5、 Rated Current:2.2A( 2.5A max)
- 6、 Stall Current:5.0A REF

### WIRING DESCRIPTION:

No.	SIGNAL	I/O	SPECIFICATION
1	Vm (Red wire) Motor power supply port	IN	12V(8.5V-18V)
2	FG(Yellow wire) Frequency pulse generator		
	VOH/TTL High level	OUT	1.5V≤V≤5V
	VOL/TTL Low level		0.6V max
	Sink current		3mA max
	Number of output pulses		6 pulse per revolution
			Yellow lead wire, this is an open-collector output (NPN), which can be used for FG output to detect the rotational speed according to the phase shift
3	CW/CCW(White wire)Motor rotation direction		
	INPUT VOLTAGE		0~5V
	VIH / TTL High level	IN	CCW: 1.5V Min ; Motor reverses
	VIL / TTL Low level		CW 0.6V max / When Voltage ≤0.6V, Motor forward
4	GND(Black wire)Ground wire	IN	
5	PWM(Blue wire)Pulse Width Modulation		
	INPUT Puls VOLTAGE/ TTL		0~5V
	VOH/High leve, TTL	IN	1.5V Min or open motor stop
	VOL/Low level, TTL		0.6V max motor drive / When voltage ≤0.6V, motor starts
	PWM SIGNAL/ Pulse range		20KHZ~30KHZ
6	BRAKE(Green wire)Brake control (Green wire)		
	INPUT TTL VOLTAGE/Input voltage		5V
	VOH/ TTL High level	IN	1.5V Min ; Motor Free
	VOL/ TTL Low level		0.6V max When voltage ≤0.6V, motor Brake

### Note:

1. The VCC and GND ports are not interchangeable for use
  2. Please switch between CW/CCW while the motor is stopped. Switching during operation may cause damage to internal electronic components bad
  3. Motor starting method: Connect the red lead to the positive power supply, black lead
- When the lead is GND and the Blue lead port is at low level, the motor Start up, the motor initially turns to CCW. When it is necessary to switch the rotating direction Both the Blue and White leads are set to low levels, Switching the motor direction
- Alternatively; for static operation: Connect Power wires and connect Blue wire to Ground Motor will turn CCW. For CW operation connect Blue with White then connect this to ground.

TITLE: GMP42-TEC4260-1250-14		Customer No:		Drafted By: He Yiqiang	
Dwg. NO: 1688		Date: 2026.03.31		Checked By:	
				Approved By:	
TT MOTOR (HK) INDUSTRIAL CO.,LTD		1:1		Units: mm	EDITION No: A
				Angular: =1° Decimal: X.XX ±0.05 X.X ±0.2 X ±0.3	