

Specification Guide Codes:

A = Item Number

B = Rated Current

- Insulating Body : Flame Retarding UL 94 V0 Thermoplastic Material.
- Contact: Nickel or Tin Plated Copper Alloy.

C = Insulation Resistance At 500 V DC

D = Contact Resistance

E = Dielectric Strength For 60 Seconds

PANEL MOUNT FUSE HOLDER FOR 1/4" x 1-1/4" (6.3x32mm) FUSES



CQ-207Q RoHS

B: 10A 250V.
C: 100MΩ Min
D: 10mΩ At 1A DC
E: AC1500V Min.

Bayonet Knob

Approvals:

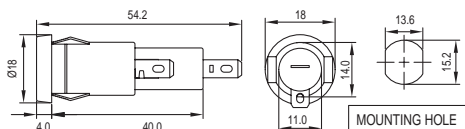

CQ-207R

B: 10A 250V.
C: 100MΩ Min
D: 10mΩ At 1A DC
E: AC1500V Min.

Bayonet Knob

Approvals:

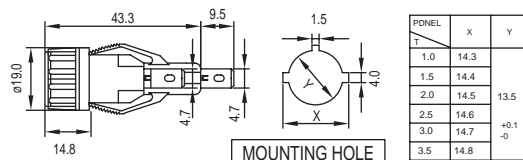

SPECIAL FUSE HOLDER



CQ-215 RoHS

For 10.3 x 38.1mm (5AG) Fuses

B: 30A 600V.
C: 100MΩ Min
D: 5mΩ At 1A DC
E: AC3000V Min.

Screw Knob

Approvals:

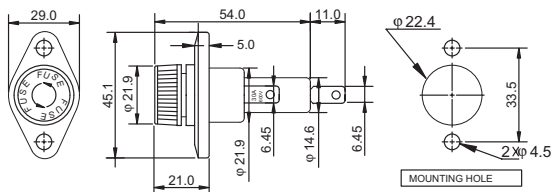

CQ-225 RoHS

For 10.3 x 38.1mm (5AG) Fuses

B: 30A 600V.
C: 100MΩ Min
D: 5mΩ At 1A DC
E: AC3000V Min.

Terminal Option:

Quick Terminal

Insulating Body:

Flame Retarding UL 94V0 Thermoplastic Material

Approvals:

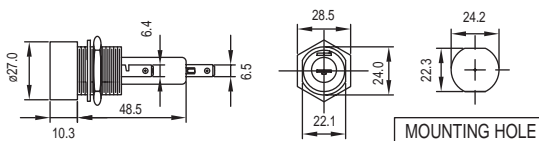

MET Fuse Holder



- A.** Housing : Glass filled polyester UL94-V0
- B.** Insulation Resistance : 103MΩ at V=100V
- C.** Temperature Range : -55°C to 125°C
- D.** Contact : Beryllium copper , Heat treated
- E.** Plating : Nickel / Tin
- F.** Current Rating : 3A
- G.** Contact Resistance : <4mA
- H.** Insertion Force : <250g
- I.** Withdrawal Force : >50g

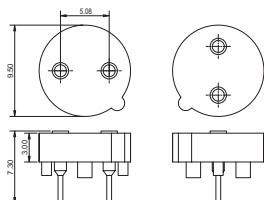

MST Fuse Holder



- A.** Housing : Glass filled polyester UL94-V0
- B.** Insulation Resistance : 103MΩ at V=100V
- C.** Temperature Range : -55°C to 125°C
- D.** Contact : Beryllium copper , Heat treated
- E.** Plating : Nickel / Tin
- F.** Current Rating : 3A
- G.** Contact Resistance : <4mA
- H.** Insertion Force : <250g
- I.** Withdrawal Force : >50g

